



**Road Running Technical Council**  
**USA Track & Field**  
**Measurement Certificate**



Name of the course Bloomin 5K Distance 5 km  
Location (state) NJ (city) Clifton  
Type of course: Road Race  
Measuring Methods: Bicycle  
Measured By Barry Lass - 6 Midland Drive - Morristown, NJ 07960 - (973) 219-6170 - barrylass@yahoo.com  
Race Contact Kevin Donahue - 380 Clifton Ave, Clifton, NJ 07011 - 201-316-3181  
Date(s) when course measured: 11/17/2019  
Number of measurements of entire course: 2 Course Configuration: same out/back  
Elevation (meters above sea level) Start 32.92 Finish 32.92 Lowest 32.92 Highest 55.78  
Straight line distance between start and finish 0 m Drop 0.00 m/km Separation 0.00 %  
Type of surface: Paved 100 % Dirt 0 % Gravel 0 % Grass 0 % Track 0 %  
Effective date of certification: November 22, 2019 Certification code: NJ19007JLW

Note to Race Director: Use this Certification Code  
in all public announcements relating to your race.

## ***Be It Officially Noted That***

Based on examination of data provided by the above named measurer, the course described above and in the map attached is hereby certified as reasonably accurate in measurement according to the standards adopted by the Road Running Technical Council. If any changes are made to the course, this certification becomes void, and the course must then be recertified.

**Verification of Course ---** In the event a National Open Record is set on the course, or at the discretion of USA Track & Field, a verification measurement may be required to be performed by a member of the Road Running Technical Council. If such a remeasurement shows the course to be short, then all pending records will be rejected and the course certification will be cancelled.

***This certification expires on December 31 of the year:*** **2029**

**AS NATIONALLY CERTIFIED BY:**

Date: November 22, 2019

Jack Werbler - USATF/RRTC Certifier - 19 Amagansett Drive, Morganville NJ 07751  
(908) 692-6686 - jwerb@optonline.net

# Bloomin 5K Clifton, NJ



**USATF Certificate**  
NJ19007JLW  
Effective: 11/22/2019  
Through: 12/31/2029

Start: On Park Slope, at fire hydrant west of Highpark Place. 9 feet 8 inches west of pole 62859C  
Mile 1: On Kuller Rd, at the first bridge piling on the right under Garden State Parkway.  
Turn : On Kuller Rd, 8 feet 3 inches past pole 68793C on left. 28 feet 5 inches before manhole cover  
Mile 2: On Kuller Rd, at the entrance to Image First on left. 23 feet 4 inches before pole E69052C on right  
Mile 3: On Day St, at the entrance to Jefferson Gardens on left  
Finish: At the same point as the Start

\* All directions are given relative to the running direction

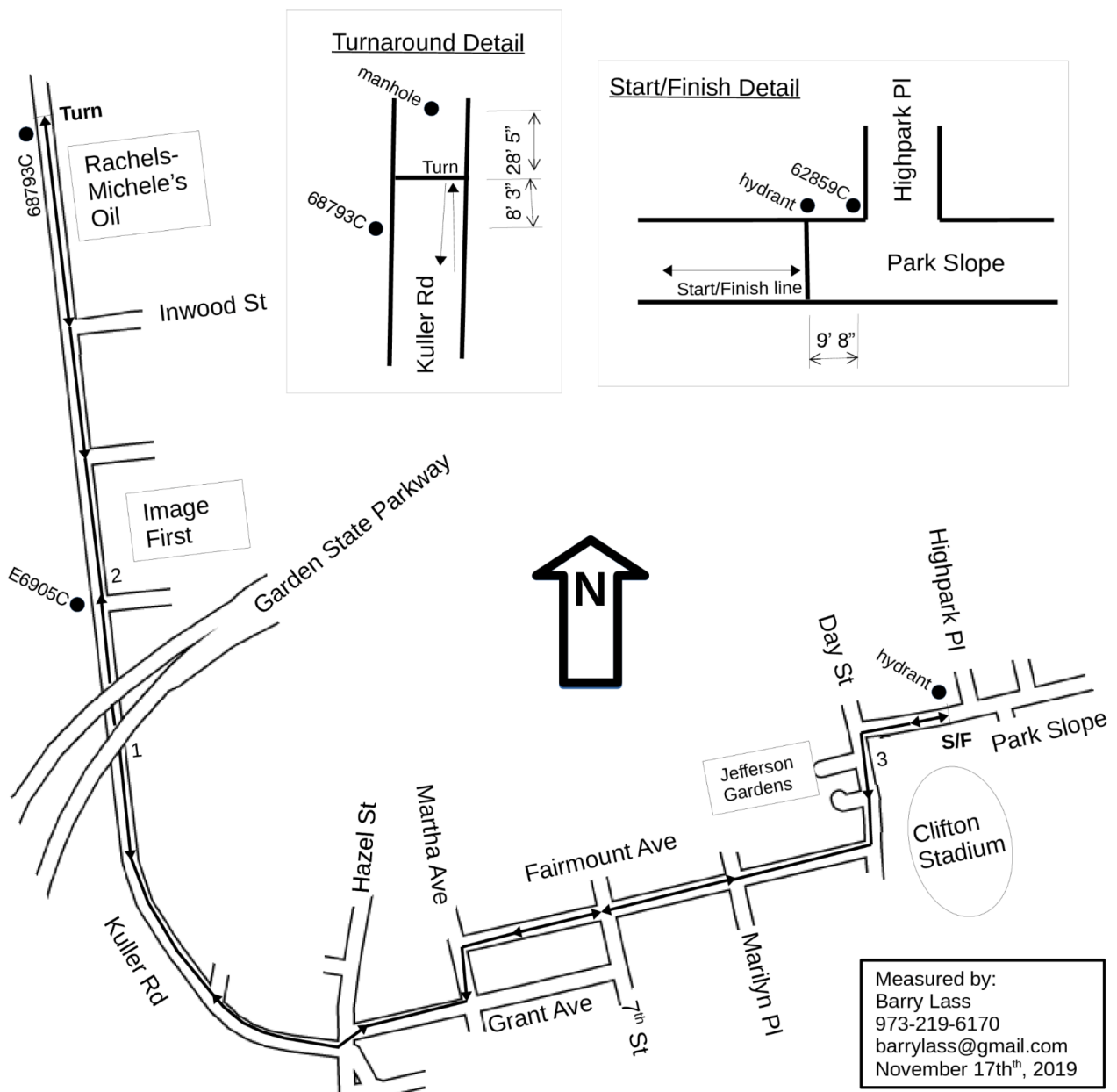

Bloomin 5K

LIST OF MEASURED POINTS:

Start: On Park Slope, at fire hydrant west of Highpark Place. 9 feet 8 inches west of pole 62859C  
Mile 1: On Kuller Rd, at the first bridge piling on the right under Garden State Parkway.  
Turn : On Kuller Rd, 8 feet 3 inches past pole 68793C on left. 28 feet 5 inches before manhole cover  
Mile 2: On Kuller Rd, at the entrance to Image First on left. 23 feet 4 inches before pole E69052C on right  
Mile 3: On Day St, at the entrance to Jefferson Gardens on left  
Finish: At the same point as the Start

\* All directions are given relative to the running direction