



**Road Running Technical Council
USA Track & Field
Measurement Certificate**



Name of the course Springtime Surprise 10 Miler Distance 10 mi
Location (state) FL (city) Lake Buena Vista
Type of course: Road Race
Measuring Methods: Bicycle
Measured By Jonathan Branson - 50 Lakeview Reserve Blvd - Winter Garden, FL 34787 - (321) 312-0787 - jbranson@acroi
Race Contact Jon Hughes - 1013 Montana Street Orlando, FL 32803 - (407) 896-1160 - info@trackshack.com
Date(s) when course measured: 11/21/2023, 11/22/2023
Number of measurements of entire course: 2 Course Configuration: partial loop
Elevation (meters above sea level) Start 29.87 Finish 31.70 Lowest 28.65 Highest 36.88
Straight line distance between start and finish 462.99 m Drop -0.11 m/km Separation 2.88 %
Type of surface: Paved 100 % Dirt 0 % Gravel 0 % Grass 0 % Track 0 %
Effective date of certification: March 1, 2024 Certification code: FL24005JK

Note to Race Director: Use this Certification Code
in all public announcements relating to your race.

Be It Officially Noted That

Based on examination of data provided by the above named measurer, the course described above and in the map attached is hereby certified as reasonably accurate in measurement according to the standards adopted by the Road Running Technical Council. If any changes are made to the course, this certification becomes void, and the course must then be recertified.

Verification of Course --- In the event a National Open Record is set on the course, or at the discretion of USA Track & Field, a verification measurement may be required to be performed by a member of the Road Running Technical Council. If such a remeasurement shows the course to be short, then all pending records will be rejected and the course certification will be cancelled.

This certification expires on December 31 of the year: **2034**

AS NATIONALLY CERTIFIED BY:

Date: March 7, 2024

Justin Kuo - USATF/RRTC Certifier - 39 Oakland Rd, Brookline MA 02445
(617) 487-4463 - jkuo+certifier@usatfne.org

SPRINGTIME
SURPRISE 10 MILER

LAKE BUENA VISTA, FLORIDA
10 MILE RACE DISTANCE

COURSE MEASURED ON 11/22/2023 BY
TOM WARD, IAAF "B" MEASURER
AND
JONATHAN BRANSON, PLS
JBRANSON@ACROMIC.COM
321-312-0787
CALIBRATION COURSE FL20009JK USED
FOR THIS RACE COURSE

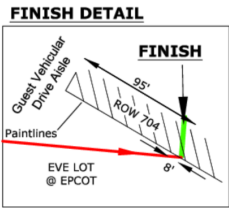
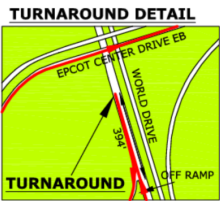
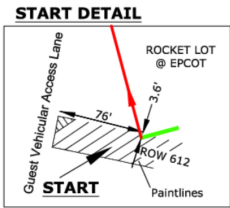
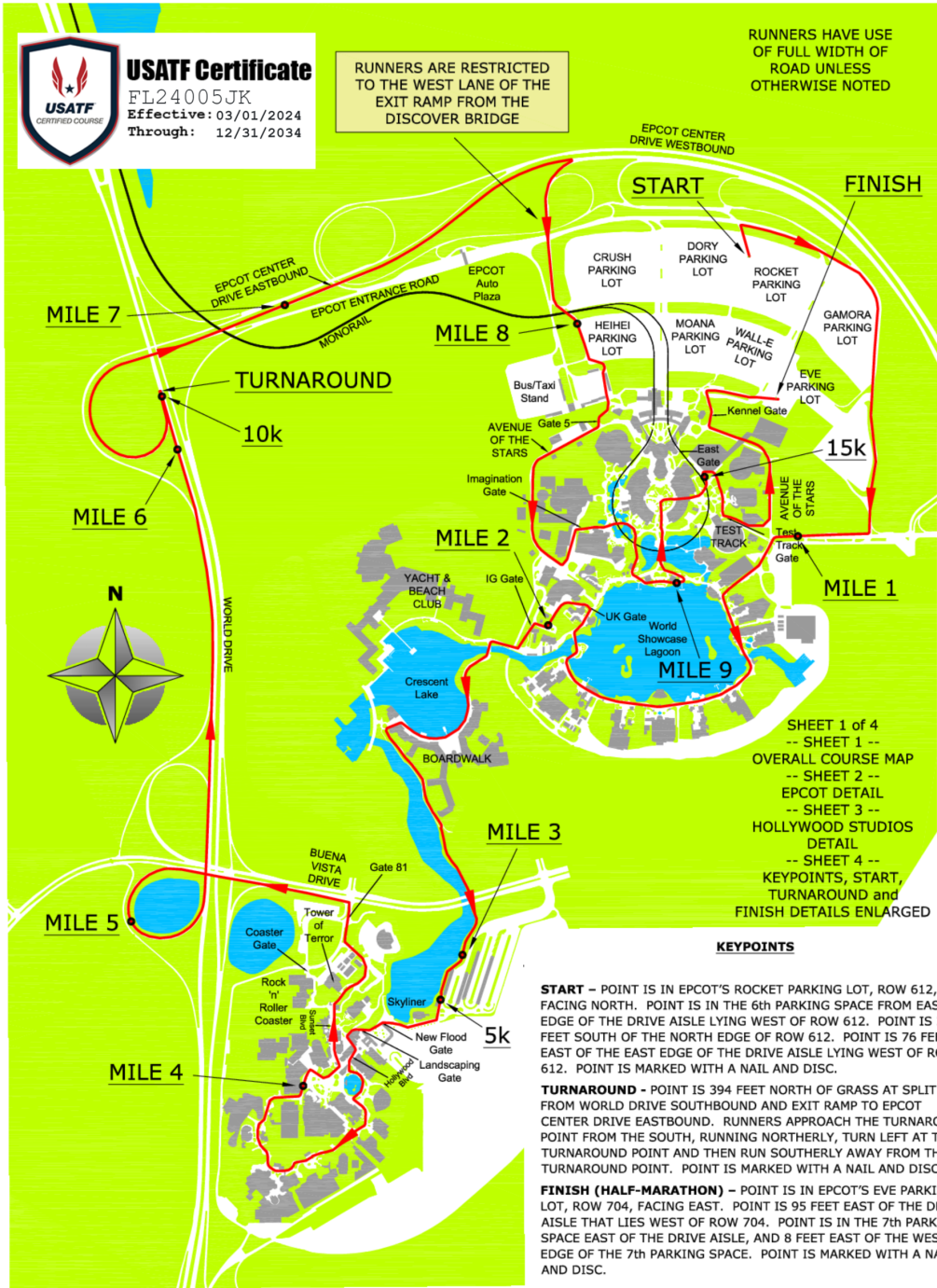

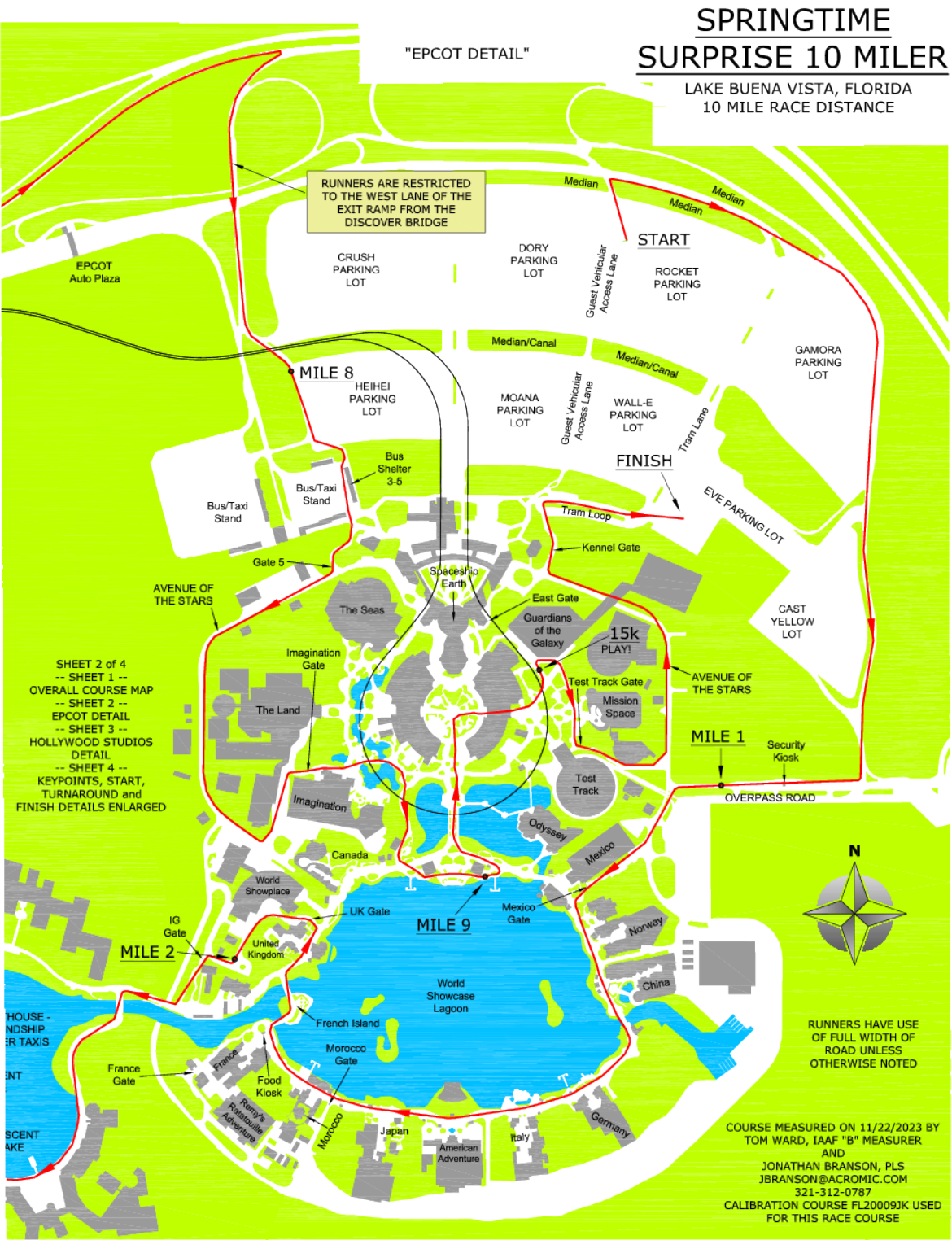

**SPRINGTIME
SURPRISE 10 MILER**

LAKE BUENA VISTA, FLORIDA
10 MILE RACE DISTANCE

"STUDIOS DETAIL"

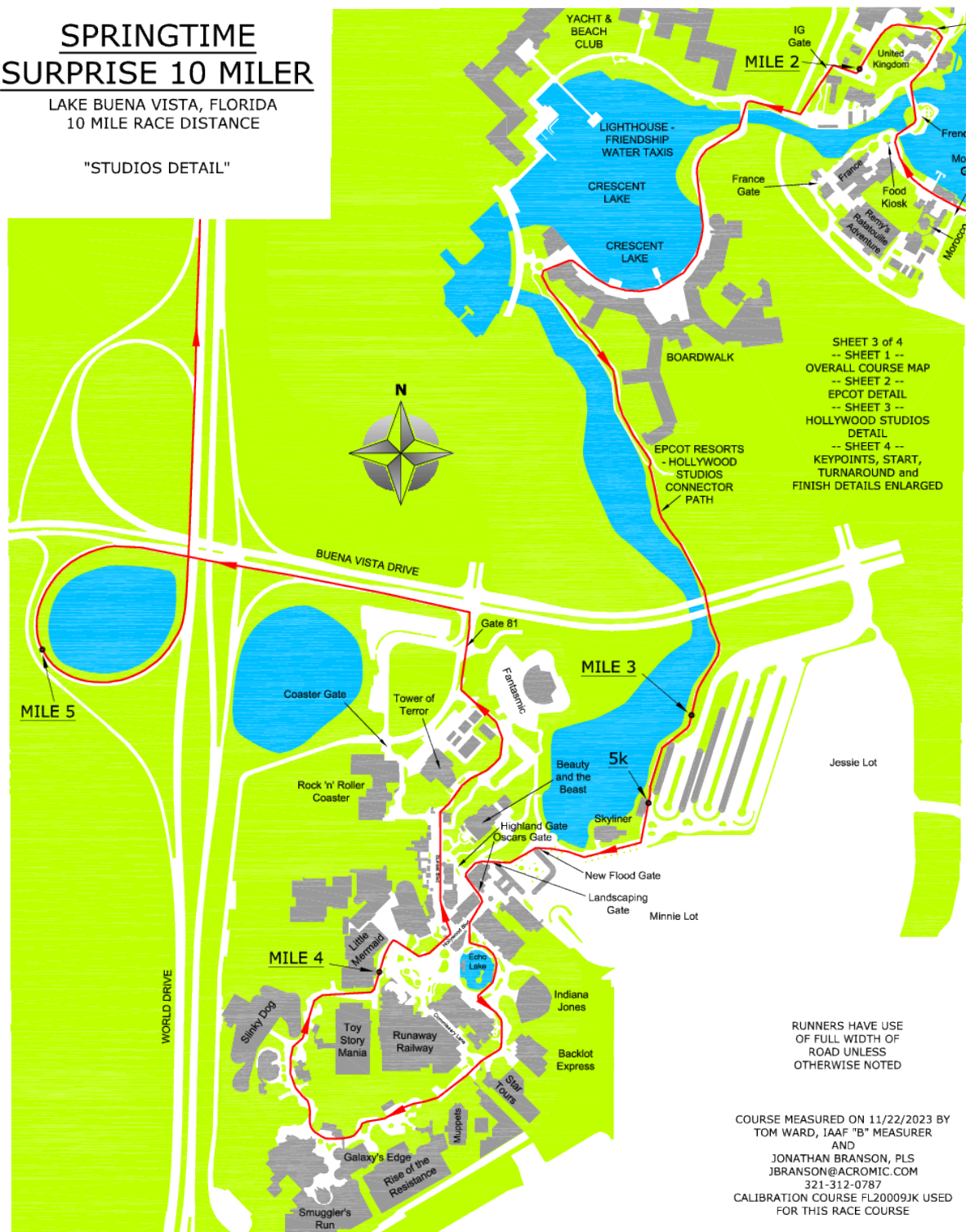

KEYPOINTS

START - POINT IS IN EPCOT'S ROCKET PARKING LOT, ROW 612, FACING NORTH. POINT IS IN THE 6th PARKING SPACE FROM EAST EDGE OF THE DRIVE AISLE LYING WEST OF ROW 612. POINT IS 3.6 FEET SOUTH OF THE NORTH EDGE OF ROW 612. POINT IS 76 FEET EAST OF THE EAST EDGE OF THE DRIVE AISLE LYING WEST OF ROW 612. POINT IS MARKED WITH A NAIL AND DISC.

1 MILE - POINT IS ON THE SOUTH EDGE OF OVERPASS ROAD, BACKSTAGE IN EPCOT, FACING WEST. POINT IS 53 FEET EAST OF (BEFORE) SIGN SAYING "PREPARE TO STOP VEHICLE SUBJECT TO SEARCH". POINT IS ALSO 95 FEET WEST OF (AFTER) WEST EDGE OF CROSSWALK AT WATER TREATMENT FACILITY. POINT IS MARKED WITH A NAIL AND DISC.

2 MILE - POINT IS ON THE NORTH/SOUTH ROAD AT THE NORTHEAST CORNER OF THE SKYLINE TERMINAL AT EPCOT, FACING SOUTH. POINT IS IN LINE WITH THE NORTH EDGE OF TRAILER B-11 (ON EAST SIDE OF UK BUS LOOP), ALSO 9.2 FEET NORTH OF (BEFORE) NORTH EDGE OF STOP BAR. POINT IS MARKED WITH A NAIL AND DISC.

3 MILE - POINT IS ON WEST SIDE OF STUDIOS PATH, NORTH OF BUS LOADING STOP 1 THROUGH 8, FACING SOUTH. POINT IS 56.2 FEET NORTH OF (BEFORE) OAK TREE AT BEND IN PATH. OAK TREE IS ONLY TREE BETWEEN THE PATH AND WATER. POINT IS NOT PERMANENTLY MARKED.

5k - POINT IS ON PATH BY BATHROOMS BETWEEN BUS LOOP AND SKYLINER AT STUDIOS, FACING SOUTH. POINT IS 9.6 FEET NORTH OF (BEFORE) CENTER OF ENTRANCE TO MEN'S RESTROOM. POINT IS NOT PERMANENTLY MARKED.

4 MILE - POINT IS ON PATH FROM ANIMATION COURTYARD TO TOY STORY LAND, FACING NORTH. POINT IS 71.8 FEET NORTH OF (AFTER) CENTER OF DOUBLE DOORS ENTRANCE TO WALT DISNEY PRESENTS THEATER. POINT IS NOT PERMANENTLY MARKED.

5 MILE - POINT IS ON EAST SIDE OF RAMP FROM WORLD DRIVE SOUTHBOUND TO BUENA VISTA DRIVE EASTBOUND, FACING NORTH. POINT IS 52.6 FEET NORTH OF (BEFORE) LIGHT POLE "LBL158". POINT IS MARKED WITH A NAIL AND DISC.

6 MILE - POINT IS ON WEST SIDE OF WORLD DRIVE SOUTHBOUND, FACING NORTH. POINT IS 31.6 FEET SOUTH OF (BEFORE) LIGHT POLE "WDS24". POINT IS MARKED WITH A NAIL AND DISC.

TURNAROUND - POINT IS 394 FEET NORTH OF GRASS AT SPLIT FROM WORLD DRIVE SOUTHBOUND AND EXIT RAMP TO EPCOT CENTER DRIVE EASTBOUND. RUNNERS APPROACH THE TURNAROUND POINT FROM THE SOUTH, RUNNING NORTHERLY, TURN LEFT AT THE TURNAROUND POINT AND THEN RUN SOUTHERLY AWAY FROM THE TURNAROUND POINT. POINT IS MARKED WITH A NAIL AND DISC.

10k - POINT IS ON EAST SIDE OF WORLD DRIVE SOUTHBOUND, FACING NORTH. POINT IS 122.2 FEET NORTH OF (AFTER) LINE WITH LIGHT POLE "WDS 16" (POLE IS ON WEST SIDE OF WORLD DRIVE SOUTHBOUND). POINT IS ALSO 28 FEET SOUTH OF (BEFORE) THE TURNAROUND POINT. POINT IS MARKED WITH A NAIL AND DISC.

7 MILE - POINT IS ON NORTH SIDE OF EPCOT CENTER DRIVE EASTBOUND, FACING EAST. POINT IS 9.6 FEET EAST OF (AFTER) LIGHT POLE "ECD 143". POINT IS MARKED WITH A NAIL AND DISC.

8 MILE - POINT IS IN NORTHWEST CORNER OF EPCOT PARKING LOT HEIHEI, FACING SOUTH. POINT IS ON WEST SIDE OF EXIT LANE BETWEEN WEST END OF ROWS 109/110, 27.6 FEET WEST OF THE CENTER OF THE STOP BAR BETWEEN ROWS 109/110. POINT IS ALSO 1 FOOT EAST OF PERMANENT YELLOW FLIP STICKS. POINT IS MARKED WITH A NAIL AND DISC.

9 MILE - POINT IS ON NORTH SIDE OF EPCOT WORLD SHOWCASE LAGOON, FACING EAST. POINT IS 13 FEET EAST OF (AFTER) EAST FACE OF DISNEY TRADERS BUILDING. POINT IS JUST SOUTH OF THE DISNEY TRADERS SHOP, BY THE LAGOON. POINT IS NOT PERMANENTLY MARKED.

15k - POINT IS ON EAST SIDE OF EPCOT BY THE GUARDIANS OF THE GALAXY ATTRACTION, FACING NORTH. POINT IS 53 FEET SOUTHWEST OF THE VIRTUAL QUEUE FOR THE GUARDIANS OF THE GALAXY ATTRACTION. POINT IS ALSO DIRECTLY EAST OF CONNECTIONS EATERY ENTRY/EXIT DOORS. POINT IS ALSO IN LINE WITH STROLLER PARKING SIGN ON WEST SIDE OF RUNNING PATH. POINT IS NOT PERMANENTLY MARKED.

FINISH (10 MILE) - POINT IS IN EPCOT'S EVE PARKING LOT, ROW 704, FACING EAST. POINT IS 95 FEET EAST OF THE DRIVE AISLE THAT LIES WEST OF ROW 704. POINT IS IN THE 7th PARKING SPACE EAST OF THE DRIVE AISLE, AND 8 FEET EAST OF THE WEST EDGE OF THE 7th PARKING SPACE. POINT IS MARKED WITH A NAIL AND DISC.

SPRINGTIME SURPRISE 10 MILER

LAKE BUENA VISTA, FLORIDA
10 MILE RACE DISTANCE

COURSE MEASURED ON 11/22/2023 BY
TOM WARD, IAAF "B" MEASURER
AND
JONATHAN BRANSON, PLS
JBRANSON@ACROMIC.COM
321-312-0787
CALIBRATION COURSE FL20009JK USED
FOR THIS RACE COURSE

SHEET 4 of 4
-- SHEET 1 --
OVERALL COURSE MAP
-- SHEET 2 --
EPCOT DETAIL
-- SHEET 3 --
HOLLYWOOD STUDIOS
DETAIL
-- SHEET 4 --
KEYPOINTS, START,
TURNAROUND and
FINISH DETAILS ENLARGED

START DETAIL

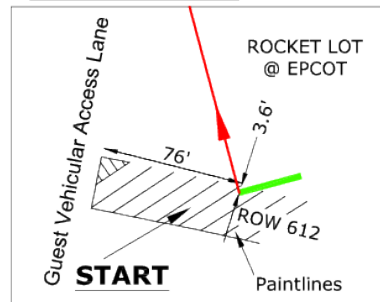

TURNAROUND DETAIL

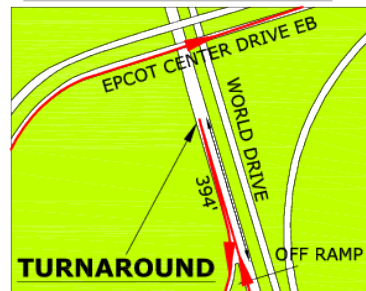

FINISH DETAIL

