

FREEDOM CHALLENGE 15K Fairview, PA

Note: course description and mile marker # descriptions are on a separate sheet of this certification.

**USATF Certificate
PA15021WB**
Effective: 05/17/2015 to 12/31/2025

Measured by
Mike Vieyra
Fairview, PA
05/14/15
814-504-2631

ELEVATIONS:
(in meters)
Start: 228.6
Finish: 228.6
Highest: 277.4
Lowest: 211.8

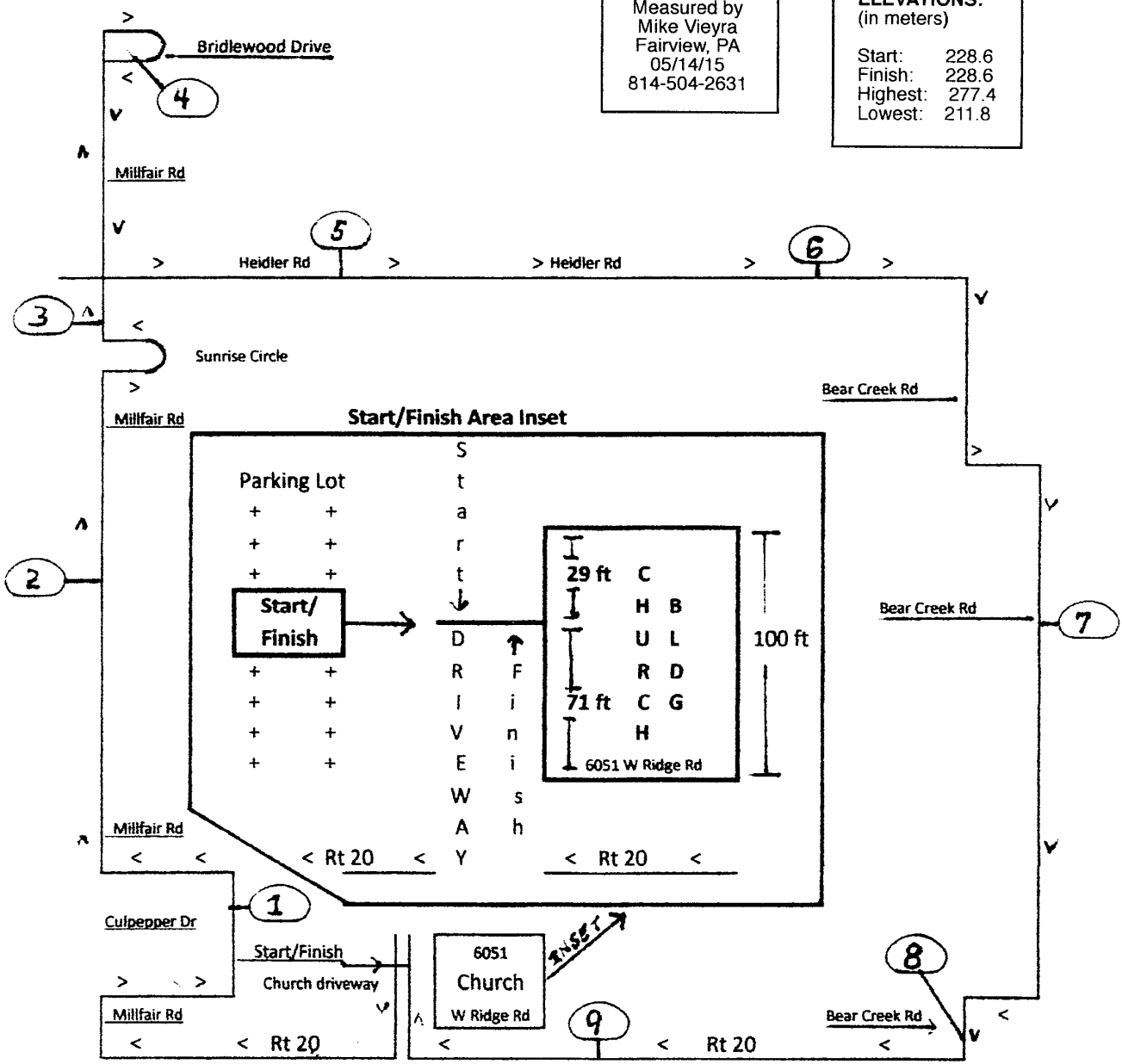



Road Running Technical Council
USA Track & Field
Measurement Certificate



Name of the course FREEDOM CHALLENGE 15K Distance 15 km

Location (state) PENNSYLVANIA (city) FAIRVIEW

Type of course: road race calibration track Configuration: ONE LOOP, ONE TIME

Type of surface: paved 100 % dirt - % gravel - % grass - % track - %

Elevation (meters above sea level) Start 228.6 Finish 228.6 Highest 277.4 Lowest 211.8

Straight line distance between start & finish 0.0 Drop 0.0 m/km Separation 0.0 %

Measured by (name, address, phone & e-mail) MIKE VIEYRA, 6674 OTTEN COURT,
FAIRVIEW, PA 16145 814-504-2631 mike.vieyra@gmail.com

Race contact (name, address, phone & e-mail) CALEB LANCASTER, 6015 W. RIDGE ROAD,
FAIRVIEW, PA 16506 814-873-2465 eriefreedomchallenge@gmail.com

Measuring Methods: bicycle steel tape electronic distance meter

Number of measurements of entire course: 2 Date(s) when course measured: 05/14/15

Race date: 05/25/15 Course certification effective date: 05/17/15

Certification code: PA15021WB

Notice to Race Director: Use this Certification Code in **all** public announcements relating to your race.

Be It Officially Noted That

Based on examination of data provided by the above named measurer, the course described above and in the map attached is hereby certified as reasonably accurate in measurement according to the standards adopted by the Road Running Technical Council. If **any** changes are made to the course, this certification becomes void, and the course must then be recertified.

Verification of Course — In the event a National Open Record is set on this course, or at the discretion of USA Track & Field, a verification remeasurement may be required to be performed by a member of the Road Running Technical Council. If such a remeasurement shows the course to be short, then all pending records will be rejected and the course certification will be cancelled.

This certification expires on December 31 in the year **2025**

AS NATIONALLY CERTIFIED BY:

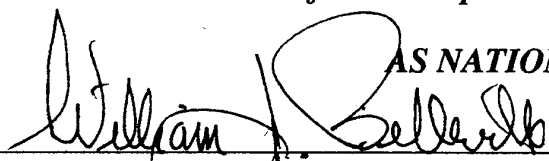
 _____ Date: 05/17/15
 William J. Belleville • USATF/RRCA Certifier
 2902 Morris Road, Ardmore, PA 19003 • (610) 649-4278 • wjbelleville1@verizon.net

Freedom Challenge 2015 Course Description

The race course is located in Fairview, PA and is a loop course that starts and ends at Walnut Creek Baptist Church at 6015 West Ridge Road, Fairview, PA. Ample parking is available at the church and the neighboring Fortis Institute (5757 West Ridge Road).

Participants will start in the church parking lot and run north to Rt 20 and turn right (east) to Millfair Rd. Then run south on Millfair Rd to Swanville Rd where the course turns right (west). The next turn will be a left (south) onto Culpepper Dr, continuing on to a T-intersection at Millfair Rd. Runners will turn right (south) and proceed to Sunrise Circle and run the semicircle in the counter clockwise direction back to Millfair Rd. Turning right (south) to continue on Millfair Rd to Bridlewood Dr where they will run that semicircle clockwise returning to Millfair Rd. A left (north) turn on Millfair Rd will bring the participants back down to Heidler Rd where they will take a left (west) turn onto Heidler.

Participants will turn right (north) off Heidler Rd onto Bear Creek Rd. Bear Creek will return to Rt 20 where participants will make a right turn (east) and proceed back to the church where they will turn right (south) into the church parking lot and onto the finish line.

Marshals and safety cones will, at a minimum, need to be placed at the following intersections to either direct runners, cross runners or control traffic:

Church drive and Rt 20, Rt 20 and Millfair Rd, Millfair Rd and Swanville Rd, Swanville Rd and Culpepper Dr, Culpepper Dr and Millfair Rd, Millfair Rd and Sunrise Circle, Sunrise Circle returning to Millfair Rd, Millfair Rd and Heidler Rd, Millfair Rd and Bridlewood Dr, Bridlewood Dr returning to Millfair Rd, Heidler Rd and Bear Creek Rd, Bear Creek Rd and Water St, Bear Creek Rd and Rt 20 and Rt 20 and Swanville Rd.

Participants will be instructed and restricted (cones and marshals) to running in the left lane at all times with these exceptions:

- 1 Both portions of the course on Rt 20 will be run in the right lane and will be coned for runners safety.
- 2 Millfair between Rt 20 and Swanville Rd will be run in the right lane because of its short duration and the elimination of two runner road crossings (two consecutive right turns).
- 3 The three semi-circles (Culpepper Dr, Sunrise Circle and Bridlewood Dr) will be run on the roadway with no lane restrictions.

Mile Marker Locations: (pink paint on edge of roadway marks locations)

Start/Finish line: located at Walnut Creek Church, 6051 W Ridge Rd, Fairview PA. See insert on map (29 ft from south end of main church bldg).

- 1 South edge of driveway at 3580 Culpepper Drive
- 2 South of Walnut Creek stream and approx 150 ft north of driveway at 4631 Millfair Rd. It is approx 95 ft north of tel pole # 20844
- 3 Directly in front of the house at 5507 Millfair – front door. Across from the north side driveway to Weis Library Church
- 4 Across from driveway at 6070 Bridlewood Drive
- 5 Just a few feet west of the west side of the driveway at 6181 Heidler Rd.
- 6 Mark located about midway between 6561 Heidler Rd and the telephone pole (#27256) to the west.
- 7 In front of the house located at 5071 Bear Creek – adjacent to the mail box
- 8 Located on Bear Creek Rd about 210 ft south of the intersection with Rt 20
- 9 Mark located on Rt 20 about 0.1 miles past "Sun Your Buns" building on south side – 60 ft west of tel pole #43203.