

Verona Labor Day Classic 5K
Verona, NJ 07044

NJ16516JHP
Effective 4/3/2016 to 12/31/2026



ALL DIRECTIONS ARE GIVEN RELATIVE TO THE RUNNING DIRECTION.

Start: On Lakeside Ave. at the water valve cap in the sidewalk in front of the leading edge of the door closest to Bloomfield Ave. for Our Lady of the Lake School building (building with the 1924 cornerstone).

Mile 1: On Forest Ave., between Howard and Pease, 3 feet before utility pole 60603VB on the right and at the driveway to house #87 on the right.

Turnaround: On Forest Ave., just before Bloomfield Ave. at the center of utility pole MD8023 / A60012VB on the left and just before the fire hydrant on the left.

Mile 2: On Hillside Ave., 8 feet after the water valve cover in the driveway to house #30 on the left.

Mile 3: On Porcello Lane in Verona Park, 19 feet 8 inches after lamp post 452 on the right and at tennis courts on left.

Finish: On Porcello Lane in Verona Park, 31 feet before lamp post 2401 on the right which is the first lamp post south of the southern path to the boat house.

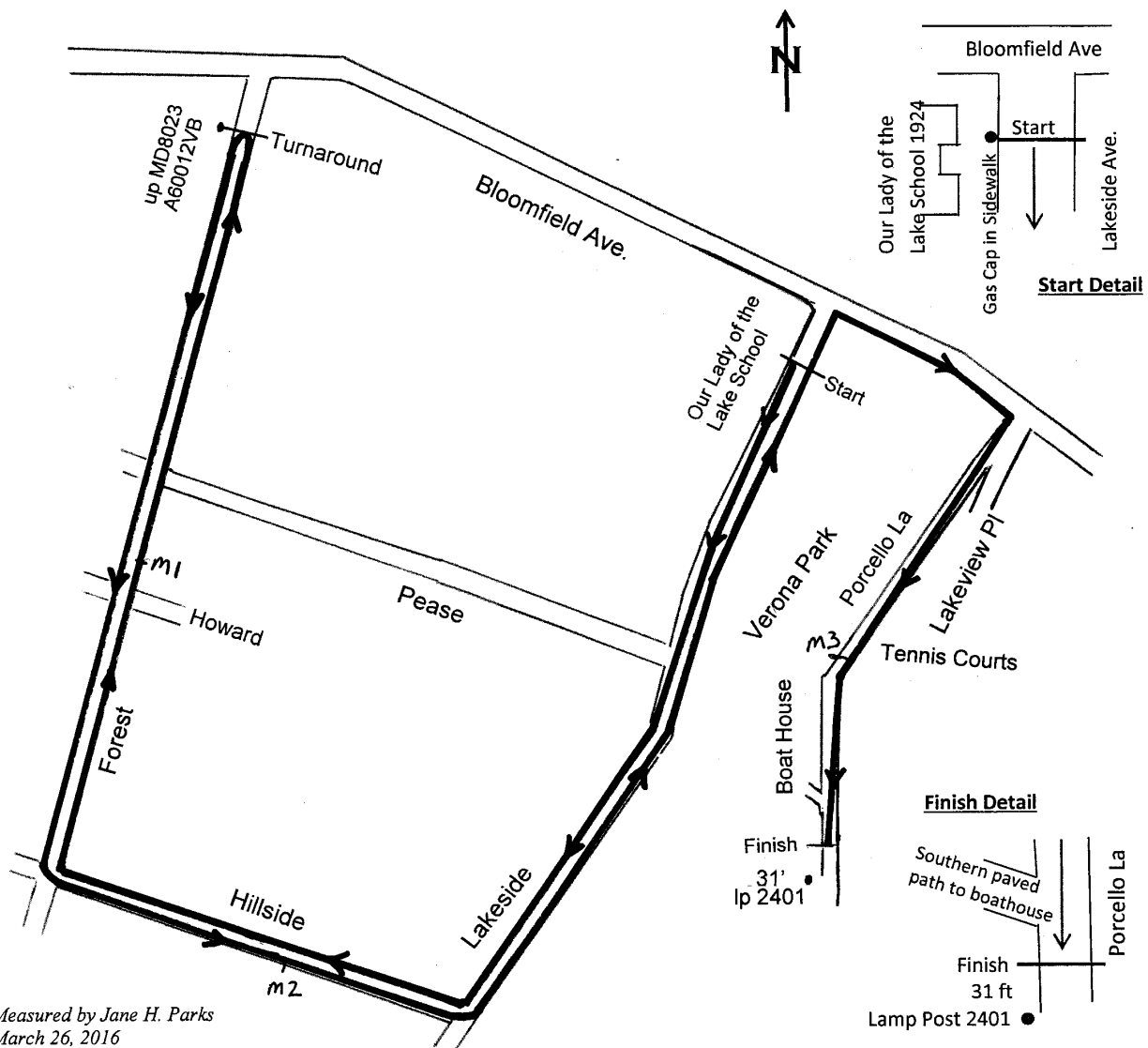

Measured by Jane H. Parks
March 26, 2016
janehp3@gmail.com



**Road Running Technical Council
USA Track & Field
Measurement Certificate**



Name of the course Verona Labor Day Classic 5K Distance 5 km
Location (state) New Jersey (city) Verona
Type of course: road race ☒ calibration course ☐ track ☐
Measuring methods: bicycle ☒ steel tape ☐ electronic distance meter ☐
Measured by (name, address, phone & e-mail) Jane H. Parks, IAAF/AIMS Grade A Measurer
973.349.0033 janehp3@gmail.com
Race contact (name, address, phone & e-mail) Mick Close, mickclose@aol.com, 973.477.0016
Date(s) when course measured: March 26, 2016
Number of measurements of entire course: 2 Course Configuration: Point to Point
Elevation (meters above sea level) Start 110 Finish 109 Highest 136 Lowest 107
Straight line distance between start & finish 504 meters Drop .2 m/km Separation 10.08 %
Type of surface: paved 100 % dirt % gravel % grass % track %
Effective date of certification: April 3, 2016 Certification code: NJ16516JHP

Notice to Race Director: Use this Certification Code
in *all* public announcements relating to your race.

Be It Officially Noted That

Based on examination of data provided by the above named measurer, the course described above and in the map attached is hereby certified as reasonably accurate in measurement according to the standards adopted by the Road Running Technical Council. If *any* changes are made to the course, this certification becomes void, and the course must then be recertified.

Verification of Course — In the event a National Open Record is set on this course, or at the discretion of USA Track & Field, a verification remeasurement may be required to be performed by a member of the Road Running Technical Council. If such a remeasurement shows the course to be short, then all pending records will be rejected and the course certification will be cancelled.

This certification expires on December 31 in the year **2026**

Jane H. Parks

AS NATIONALLY CERTIFIED BY:

Date: April 3, 2016

Jane H. Parks - USATF/RRTC Certifier
973.349.0033 janehp3@gmail.com