

DESCRIPTION: PARTICIPANTS MAY USE ALL OF PATH DESCRIBED. EVENT STARTS IN CITY PARK PARKING LOT. PROCEEDS W TO BIRCH AV. LEFT (S) TO 1<sup>ST</sup> ST. RIGHT (W) TO LAKESHORE DR. LEFT (S) TO PATH ALONG S SIDE OF HWY. STRAIGHT TO INTERSECTION OF LAKESHORE DR + ARROWHEAD LN. RIGHT (W) TO ACCESS PATH TO MUNGER TR. RIGHT (N) TO TR. LEFT (S) TO TURNAROUND. N TO 500 TR. LEFT (N) TO ACCESS PATH TO ARROWHEAD LN. RIGHT (S) TO INTERSECTION OF INDUSTRIAL RD. + ARROWHEAD LN. CROSS ARROWHEAD TO BIRCH AV. LEFT (S) TO 4<sup>TH</sup> ST. LEFT (E) INTO PARK. RIGHT (S) INTO PARKING LOT. RIGHT (W) TO FINISH.

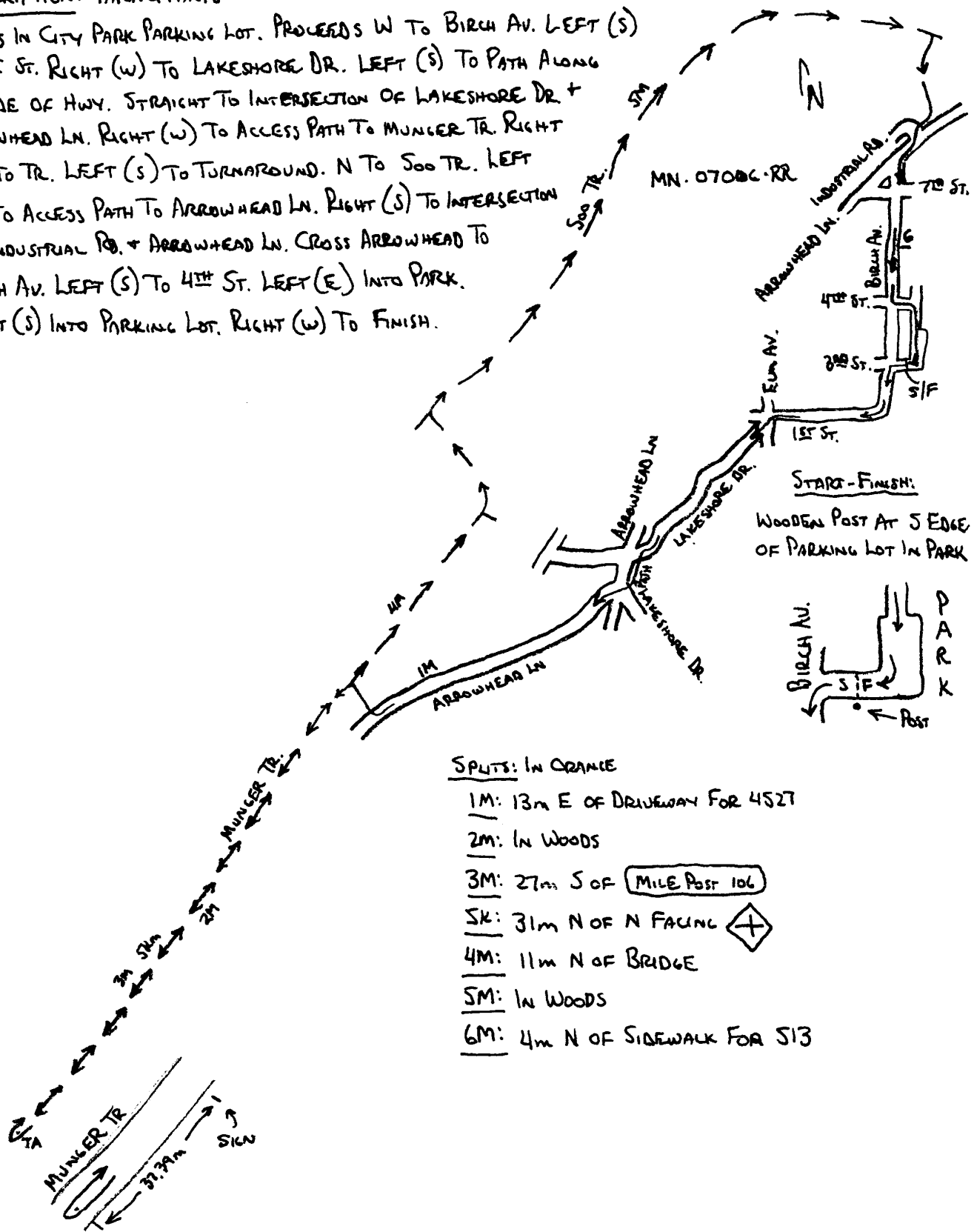

- SPLITS: IN CRANCE
- 1M: 13m E OF DRIVEWAY FOR 4527
  - 2M: IN WOODS
  - 3M: 27m S OF MILE POST 106
  - 5K: 31m N OF N FACING +
  - 4M: 11m N OF BRIDGE
  - 5M: IN WOODS
  - 6M: 4m N OF SIDEWALK FOR 513

TURN AROUND: 37.39m S OF N FACING STOP AHEAD