

Walt Disney World Marathon 2014

Lake Buena Vista, FL

Measured by Toni Youngman,
USATF Certified/IAAF Grade B Measurer
tony@runzamak.net
(407)619-2797
May 8 & 9, 2012
Adjusted 11-14-13

KEY POINTS

START ON THE SOUTH SIDE OF EPCOT CENTER DRIVE WESTBOUND LANES, FACING WEST. POINT IS 44 FEET EAST OF OVERHEAD SIGN ON THE EASTBOUND LANES "ALL GUEST AREAS NEXT RIGHT". FINISH IN EPCOT'S IMAGINE PARKING LOT, ROW 61, FACING NORTHEAST. POINT IS ON THE SOUTHWEST EDGE OF THE PARKING ROW, IN THE MIDDLE OF THE 18TH PARKING SPACE (206 FEET) FROM THE NORTHWEST EDGE OF THE PARKING ROW.

- 1 MILE ON EPCOT CENTER DR, FACING WEST. POINT IS 44 FEET WEST OF (AFTER) LINE WITH LP EL211 ON EPCOT ENTRANCE ROAD RUNNING ALONGSIDE AND NORTH OF EPCOT CENTER DR.
- 2 MILE ON THE EAST SIDE OF WORLD DR NORTHBOUND LANES, FACING NORTH. POINT IS 8 FEET SOUTH OF (BEFORE) STOP SIGN AT THE SOUTH EDGE OF ONLY PAVED MEDIAN BREAK ON WORLD DRIVE.
- 3 MILE ON WEST SIDE WALT DISNEY WORLD'S MAGIC KINGDOM PARKING LOT ENTRANCE ROAD, AT SOUTHEAST CORNER OF "RICHARD PETTY DRIVING EXPERIENCE" INDY TRACK, FACING NORTH. POINT IS 26 FEET NORTH OF SIGN "RIDE OR DRIVE TODAY, 1-800-BEPETTY, RICHARD PETTY DRIVING EXPERIENCE".
- 4 MILE AT THE EXIT OF WALT DISNEY WORLD "TICKET AND TRANSPORTATION CENTER" (TTC), FACING NORTH. POINT IS 16 FEET NORTH OF (AFTER) CHASE ATM.
- 5 MILE ON PARK 1 SECURITY GATE ACCESS ROAD, FACING WEST. POINT IS 1 FOOT WEST OF STOP BAR TO WORLD DRIVE.
- 6 MILE IN WALT DISNEY WORLD MAGIC KINGDOM, FRONTIERLAND, FACING WEST. POINT IS 11 FEET EAST OF (BEFORE) LINE WITH MIDDLE OF DOUBLE DOORS TO TOWN HALL 1867.
- 7 MILE IS ON NORTHBOUND LANE OF FLORIDIAN WAY, FACING SOUTH. POINT IS 45 FEET SOUTH OF (AFTER) DOUBLE "SERVICE & AUTHORIZED VEHICLES ONLY" SIGNS, NORTH OF THE GRAND FLORIDIAN HOTEL ENTRANCE.
- 8 MILE ON NORTHBOUND SIDE OF FLORIDIAN WAY, FACING SOUTH. POINT IS 26 FEET NORTH OF (BEFORE) LINE WITH STOP SIGN AT THE SIMBA PARKING LOT DUMP GATE ENTERING ONTO FLORIDIAN WAY.
- 9 MILE ON THE INSIDE OF THE TRACK LOOP FOR "RICHARD PETTY DRIVING EXPERIENCE" INDY TRACK, FACING WEST. POINT IS ON THE SOUTH EAST EDGE OF THE LOOP, 101 FEET WEST OF "INTERSTATE 4/192" ROAD SIGN SITUATED ON WORLD DRIVE SOUTHBOUND LANES, SOUTH OF THE WALL SURROUNDING THE TRACK.
- 10 MILE ON THE WEST SIDE OF BEAR ISLAND ROAD, FACING SOUTH. POINT IS 97 FEET SOUTH OF (AFTER) SOUTH EDGE OF SOUTH EXIT TO CELL TOWER LOOP.
- 11 MILE ON WEST SIDE OF BEAR ISLAND ROAD, FACING SOUTH. POINT IS 169 FEET NORTH OF (BEFORE) LINE WITH STOP SIGN AT ACCESS ROAD "SOUTH SERVICE LANE" FOR THE FOOD WASTE COMPOST FACILITY.
- 12 MILE ON BACKSTAGE OF DISNEY ANIMAL KINGDOM (DAK), ON THE EAST SIDE OF WERIKHE WAY, FACING SOUTH. POINT IS ACROSS FROM COMPOUND F AND 75 FEET NORTH OF (BEFORE) TRAIN TRACKS CROSSING WERIKHE WAY.
- 13 MILE ON BACKSTAGE DAK, ON THE NORTH SIDE OF SAVANNAH CIRCLE, FACING WEST. POINT IS 64 FEET 6 INCHES BEFORE LINE WITH HIGH ELECTRICAL VOLTAGE BOX P661 AT BACK OF DINOSAUR BUILDING.
- TURN POINT IN MIDDLE OF SAVANNAH CIRCLE, ON THE WEST EDGE OF WATER ACCESS COVER. POINT IS 3'-10" WEST OF LINE WITH LP AT LYFT STATION 68.

HALF MARATHON ON BACKSTAGE OF DAK, ON THE NORTH SIDE OF SAVANNAH CIRCLE, FACING EAST. POINT IS 98 FEET EAST OF STOP BAR AT INTERSECTION OF SAVANNAH CIRCLE/RESTAURANTASAUROS RD.

14 MILE ON EAST SIDE OF OSCEOLA PARKWAY RAMP, LEAVING DAK PARK, FACING SOUTH. POINT IS 31 FEET SOUTH OF (AFTER) LP OPR11.

15 MILE ON SOUTH SIDE OF OSCEOLA PARKWAY EASTBOUND, FACING EAST. POINT IS 16 FEET EAST OF (AFTER) LP OP111 AT WEST EDGE OF OVERPASS TO BUENA VISTA DR.

16 MILE ON SOUTH SIDE OF OSCEOLA PARKWAY EASTBOUND, FACING EAST. POINT IS 44 FEET EAST OF LP OP45.

17 MILE ON WEST SIDE OF VICTORY WAY SOUTHBOUND LANES, FACING SOUTH. POINT IS 86 FEET NORTH OF (BEFORE) LINE WITH STOP SIGN ON WDI ROAD TO VICTORY WAY.

18 MILE IN ESPN WIDE WORLD OF SPORTS COMPLEX, ON PATH AT NORTH END OF SOFTBALL FIELDS, FACING EAST. POINT IS 47 FEET WEST OF (BEFORE) WEST FACING SIDE OF RESTROOM TRAILER AT SOUTH END OF "SPORTS EXPERIENCE".

19 MILE IN ESPN WIDE WORLD OF SPORTS COMPLEX, SOUTH OF SOFTBALL FIELD 11, FACING NORTHEAST. POINT IS 43 FEET SOUTH OF LINE WITH RIGHT FIELD FOUL POLE.

20 MILE ON EAST SIDE OF VICTORY WAY SOUTHBOUND LANES, FACING NORTH. POINT IS 62 FEET SOUTH OF (BEFORE) LINE WITH STOP SIGN ON WDI ROAD TO VICTORY WAY.

21 MILE ON NORTH SIDE OF OSCEOLA PKWY WESTBOUND LANES, FACING WEST. POINT IS 7 FEET EAST OF (BEFORE) LP OP40.

22 MILE ON EAST SIDE OF WORLD DRIVE RAMP TO BUENA VISTA DR, FACING NORTH. POINT IS 38 FEET NORTH OF (AFTER) LP LBR128.

23 MILE IN DISNEY HOLLYWOOD STUDIOS, ON NORTH SIDE OF TRAM PICKUP LANE AT THE AFI (AMERICAN FILM INSTITUTE) BUILDING (LOAD ZONE FOR BACKLOT STUDIOS TOUR), FACING EAST. POINT IS 47 FEET WEST OF (BEFORE) LINE WITH EAST FACING WALL OF AFI.

24 MILE ON STUDIOS PATH FROM BOARDWALK HOTEL, FACING NORTH. POINT IS 2 FEET SOUTH OF (BEFORE) SIGN "HOLLYWOOD STUDIOS -> / THE BOARDWALK <-". 11 FEET SOUTH OF STAIRS TO PATHWAY TO MAIN POOL AT BOARDWALK HOTEL.

25 MILE IN EPCOT IN THE MIDDLE OF THE FRANCE/ENGLISH BRIDGE. POINT IS 19 FEET NORTH OF (BEFORE) COBBLESTONE ON THE FRENCH SIDE OF THE BRIDGE.

26 MILE IN BACKSTAGE EPCOT, FACING NORTH. POINT IS IN LINE WITH MANHOLE COVER ON SOUTH END OF BUS TURNAROUND.

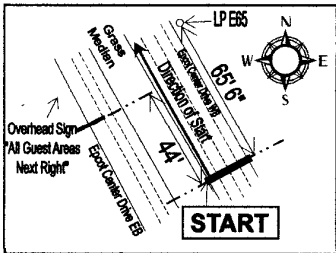
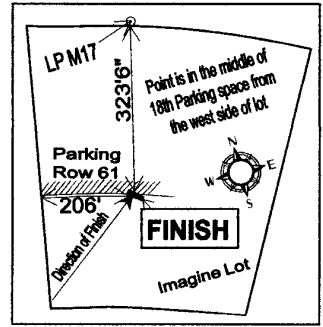
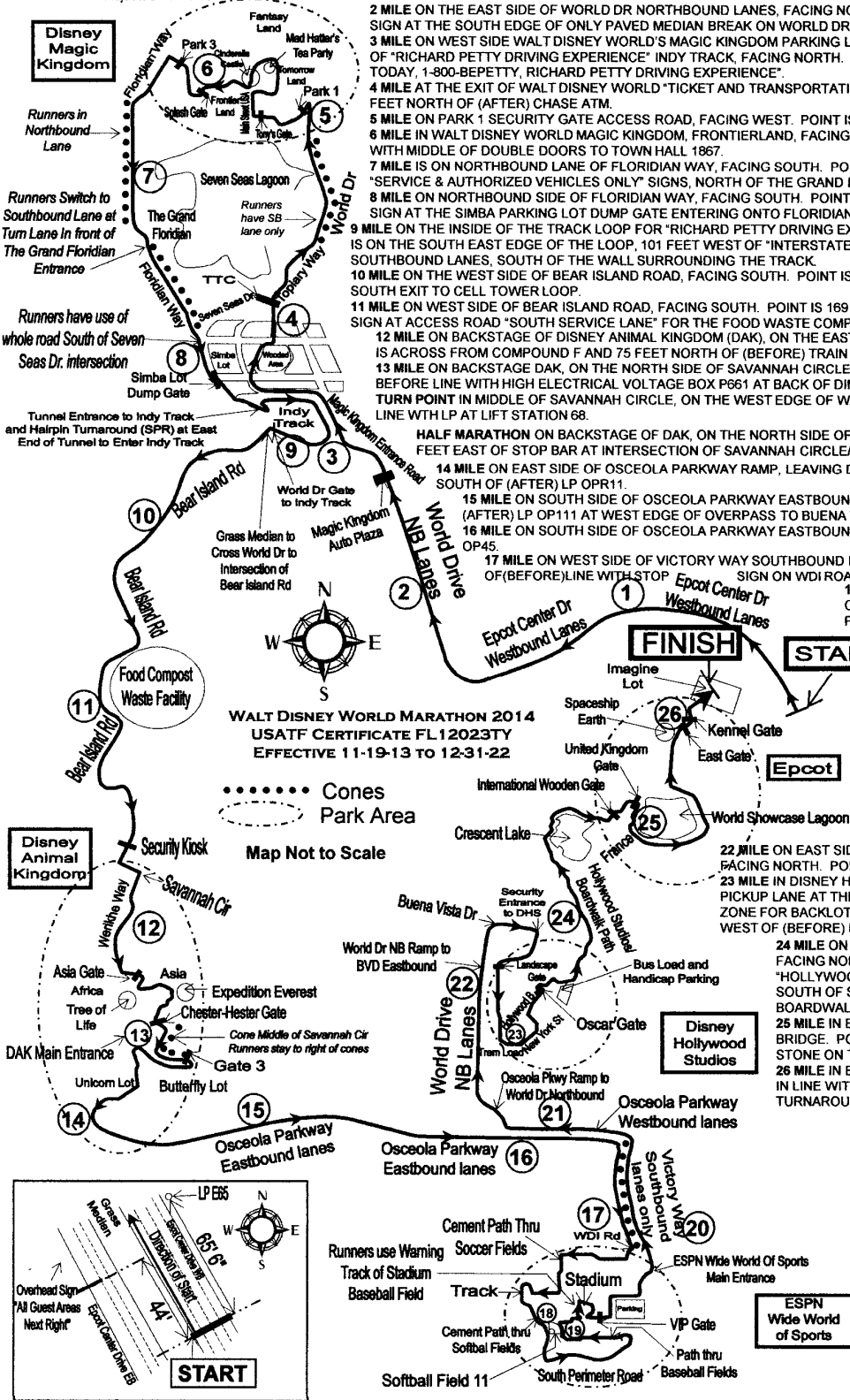



Road Running Technical Council
USA Track & Field

Measurement Certificate



Name of the course Walt Disney World Marathon 2014 Distance 42.195 km

Location (state) Florida (city) Lake Buena Vista

Type of course: road race calibration track Configuration: Loop

Type of surface: paved 100 % dirt % gravel % grass % track %

Elevation (meters above sea level) Start 28 m Finish 29 m Highest 31 m Lowest 22 m

Straight line distance between start & finish 606 m Drop -0.02 m/km Separation 1.44 %

Measured by (name, address, phone & e-mail) Toni Youngman, 12895 Downstream Circle, Orlando Florida 32828, (407)619-2797, toni@runzamok.net

Race contact (name, address, phone & e-mail) Jon Hughes, 1013 Montana Street, Orlando Florida 32803, (407)896-1160, jon@trackshack.com

Measuring Methods: bicycle steel tape electronic distance meter

Number of measurements of entire course: 2 Date(s) when course measured: 5-8-12, 5-10-12, 11-14-13

Race date: January 5, 2014 Course certification effective date: November 19, 2013

Certification code: FL12023TY

Notice to Race Director: Use this Certification Code in *all* public announcements relating to your race.

Be It Officially Noted That

Based on examination of data provided by the above named measurer, the course described above and in the map attached is hereby certified as reasonably accurate in measurement according to the standards adopted by the Road Running Technical Council. If *any* changes are made to the course, this certification becomes void, and the course must then be recertified.

Verification of Course — In the event a National Open Record is set on this course, or at the discretion of USA Track & Field, a verification remeasurement may be required to be performed by a member of the Road Running Technical Council. If such a remeasurement shows the course to be short, then all pending records will be rejected and the course certification will be cancelled.

This certification expires on December 31 in the year 2022

AS NATIONALLY CERTIFIED BY:

Date: November 19, 2013

Toni Youngman – USATF/RRCA National Certifier
12895 Downstream Circle, Orlando, FL 32828, (407) 619-2797, toni@runzamok.net