



CT19019JHP

Effective Jul 11, 2019 to Dec 31, 2029

NEWTOWN TURKEY TROT

3.149078-MI OR 5.0679498K
(223-FT LONGER THAN 5K)

NEWTOWN, CT

MEASURED ON: 7/9/2019 ALONG THE
SHORTEST ROUTE WITHIN THE EDGES OF THE
PAVED ROADS

ELEVATIONS: START 470-FT; FINISH 465-FT;
HIGHEST 495-FT; LOWEST 410-FT
SEPARATION BETWEEN START AND FINISH:
410-FT

MEASURED BY: GUIDO BROTHERS ESCORT SERVICE

pvolkmart@snet.net



0 MILES

ELEV ELEVATION

- THE MILES-
1. ON WEND OVER RD. 10-FT BEFORE (NORTH OF) POLE 1130 AND DRIVEWAY 19.
 2. ON QUEEN ST. AT DRIVEWAY #31 (RED GARAGE). 15-FT BEFORE (SOUTH OF) THE FRONT DOOR OF #31.
 3. ON GRAND PL. AT POLE 4183. 40-FT PAST DRIVEWAY #3.
 - 5K: ON QUEEN ST. 55-FT BEFORE THE INTERSECTION WITH GLOVER AVE.

-THE ROUTE-

START IN THE NEWTOWN MIDDLE SCHOOL NORTH DRIVEWAY. TURN RIGHT ONTO QUEEN ST. TURN RIGHT ONTO CHURCH HILL RD. TURN LEFT ONTO THE BLVD. TURN LEFT ONTO SCHOOLHOUSE RD. TURN LEFT ONTO WEND OVER RD. TURN LEFT ONTO CHURCH HILL RD. TURN RIGHT ONTO QUEEN ST. TURN RIGHT ONTO GLOVER AVE. TURN LEFT ONTO MEADOW RD. TURN LEFT ONTO ELIZABETH ST. TURN LEFT ONTO QUEEN ST. TURN RIGHT ONTO GRAND PL. CONTINUE ON GRAND PL. IN A COUNTERCLOCKWISE AROUND (3 LEFT TURNS). TURN RIGHT ONTO GRAND PL. TURN RIGHT ONTO QUEEN ST. TURN RIGHT INTO THE NEWTOWN MIDDLE SCHOOL SOUTH PARKING LOT. FINISH IN THE PARKING LOT.

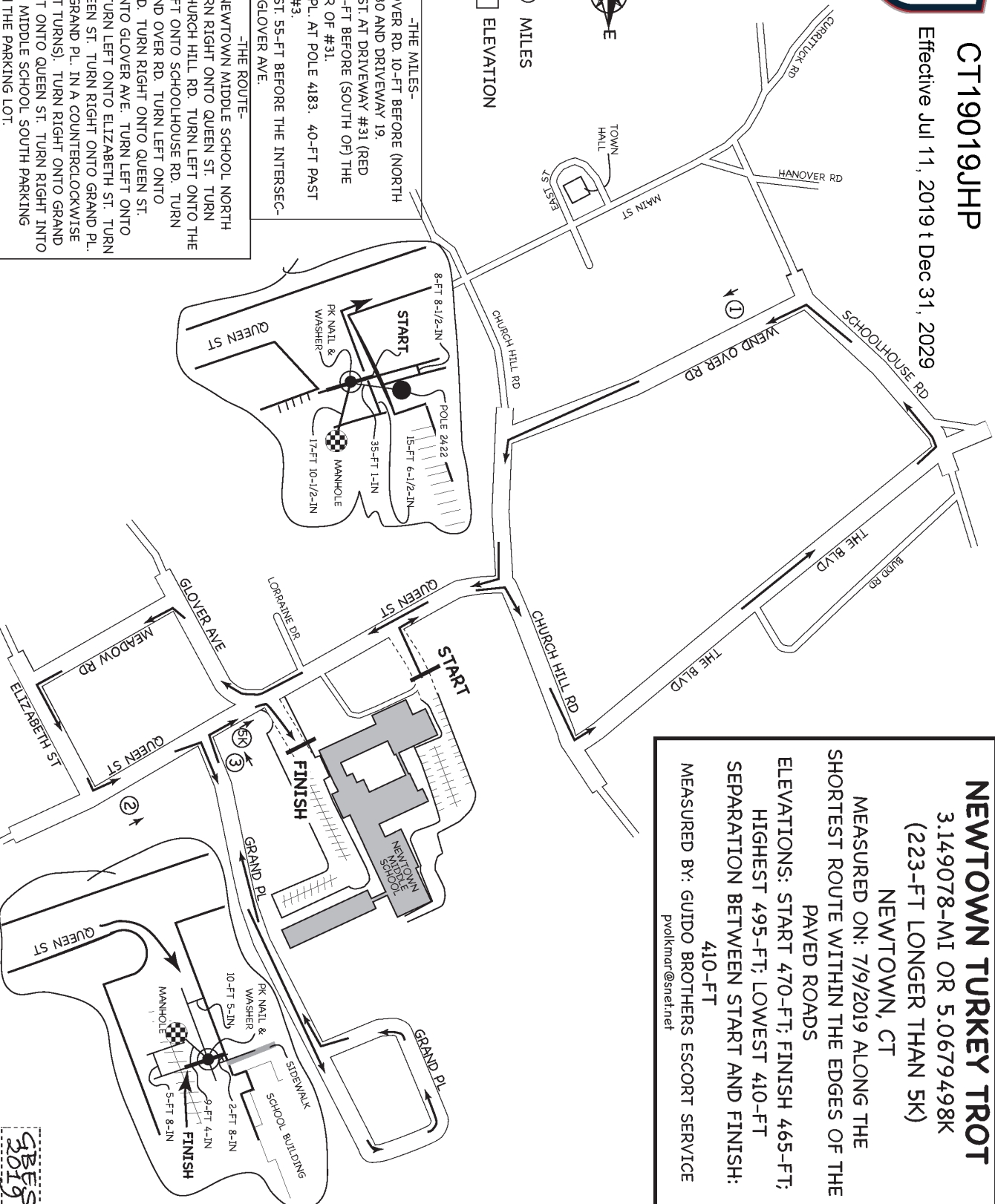

GBES
2019



*Road Running Technical Council
USA Track & Field*
Measurement Certificate



Name of the course Newtown Turkey Trot Distance 5.0679498 km
Location (state) Connecticut (city) Newtown
Type of course: road race ☒ calibration course ☐
Measuring method: bicycle ☒ steel tape ☐ electronic distance meter ☐
Measured by (name, address, phone & e-mail) Guido Brothers Escort Service, 174 Plant St. New London, CT
pvolkmar@snet.net, 860.437.7247
Race contact (name, address, phone & e-mail) Tom Long, 3 Birch Rise Drive, Newtown, CT 06470
203.313.5507
Date(s) when course measured: July 9, 2019
Number of measurements of entire course: 2 Course Configuration: Point to Point
Elevation (meters above sea level) Start 143 Finish 142 Highest 151 Lowest 125
Straight line distance between start & finish 125 Drop 0.2 m/km Separation 2.5 %
Type of surface: paved 100 % dirt % gravel % grass % track %
Effective date of certification: July 11, 2019 Certification code: CT19019JHP

Notice to Race Director: Use this Certification Code
in *all* public announcements relating to your race.

Be It Officially Noted That

Based on examination of data provided by the above named measurer, the course described above and in the map attached is hereby certified as reasonably accurate in measurement according to the standards adopted by the Road Running Technical Council. If *any* changes are made to the course, this certification becomes void, and the course must then be recertified.

Verification of Course — In the event a National Open Record is set on this course, or at the discretion of USA Track & Field, a verification remeasurement may be required to be performed by a member of the Road Running Technical Council. If such a remeasurement shows the course to be short, then all pending records will be rejected and the course certification will be cancelled.

This certification expires on December 31 in the year **2029**

AS NATIONALLY CERTIFIED BY:

Jane H. Parks

Date: July 11, 2019

Jane H. Parks – USATF/RRTC Certifier
973.349.0033 janehp3@gmail.com