

USATF Certificate CA17064RS
Effective 11/10/17 to 12/31/27

2017

Emma Wood Marathon

800 W. Main ST Ventura CA 93001
Bill Escobar bill@elitesportsca.com

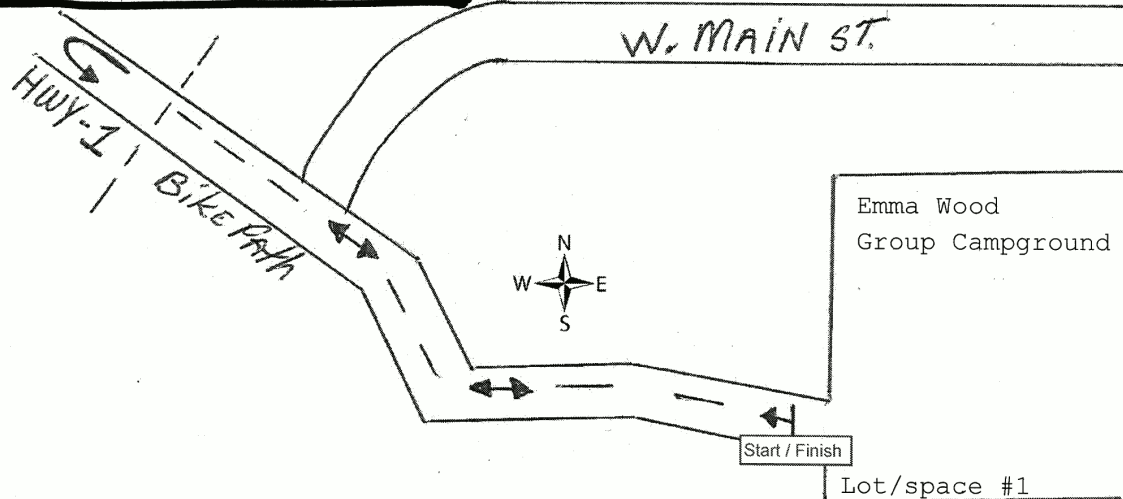

Full Marathon - 2 loops of this course: Start at Emma Wood Group Campground. Run north onto the bike path, then onto Hwy 1 along the Rincon HWY-1 in the shoulder of the road or bike lane. Turn around at the designated turn around point for your race distance and back to the starting line to finish or start of your second loop.

Start / Finish line: Emma Wood Group Campground Parking lot # 1 Start / Finish line is .11 miles east of bike path entrance in parking lot. **Full Marathon loop 2 turn around** is at Start Finish line noted on map. Start / Finish line is marked by a steel washer in the ground

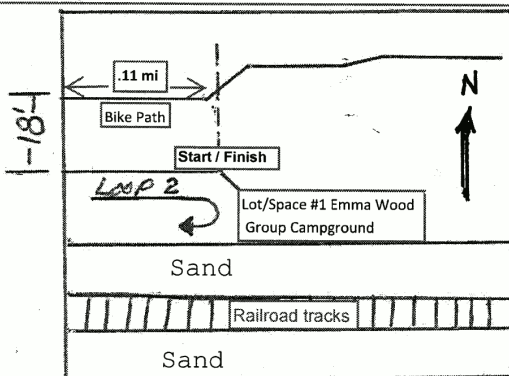

Turn around: HWY-1 at RV space #16

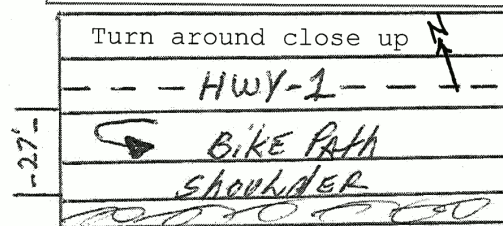



**Road Running Technical Council
USA Track & Field**

Measurement Certificate

recognized by



Name of the course 2017 Emma Wood Marathon Distance 42.195 km

Location (state) California (city) Ventura

Type of course: road race ☒ calibration course ☐

Measuring Methods: bicycle ☒ steel tape ☐ electronic distance meter ☐

Measured by (name, address, phone & email) Bill Escobar 805.258.3779
80 Deloz Dr Camarillo, CA 93012 bill@elitesportsca.com

Race contact (name, address, phone & email) Bill Escobar 805.258.3779
80 Deloz Dr Camarillo, CA 93012 bill@elitesportsca.com

Date(s) when course measured: November 5, 9, 2017

Number of measurements of entire course: 2+ Course Configuration: Two loops

Elevation (meters above sea level) Start 4.5 m Finish 4.5 Highest 22 Lowest 1.5

Straight line distance between start & finish 0 Drop 0 m/km Separation 0 %

Type of surface: paved 100 % dirt % gravel % grass % track %

Effective date of certification: November 10, 2017 Certification code: CA17064RS

Notice to Race Director: Use this Certification Code
in *all* public announcements relating to your race.

Be It Officially Noted That

Based on examination of data provided by the above named measurer, the course described above and in the map attached is hereby certified as reasonably accurate in measurement according to the standards adopted by the Road Running Technical Council. If *any* changes are made to the course, this certification becomes void, and the course must then be recertified.

Verification of Course — In the event a National Open Record is set on this course, or at the discretion of USA Track & Field, a verification remeasurement may be required to be performed by a member of the Road Running Technical Council. If such a remeasurement shows the course to be short, then all pending records will be rejected and the course certification will be cancelled.

This certification expires on December 31 in the year 2027

AS NATIONALLY CERTIFIED BY:

Date: November 10, 2017

Ron Scardera — USATF/RRTC Certifier

5660 Valley Oak Drive, Los Angeles, CA 90068 - 323.896.7750 - rscar@pacbell.net

Mile Markers - Emma Wood		2017
Mile	Description	
1	.05 mi East of Pole #1781896E on bike path	
2	HWY-1 no parking sign C48	
3	HWY-1 no parking sign C20	
4	.03 mi East of HWY-1 no parking sign B22	
5	3936 Pacific Coast HWY	
6	Hwy -1 RV Space #77	
U-Turn	HWY-1 RV Space #18	
7	HWY-1 RV Space #69	
8	4002 Pacific Coast HWY	
9	HWY-1 no parking sign #B21	
10	2812 Pacific Coast HWY	
11	HWY-1 no parking sign C46	
12	.05 west of pole #1781896E on bike path	
13	beginning of bike path at 15 mph sign	
14	.03 east of pole #1781895E	
15	20 ft west of no parking sign C50 on HWY-1	
16	no parking sign C24 on HWY-1	
17	30 ft west of no parking sign B25 on HWY-1	
18	3884 Pacific Coast HWY	
19	HWY-1 RV space #85	
20	HWY-1 RV space #61	
21	.02 west of 4044 Pacific Coast HWY	
22	30 ft west of no parking sign #B18 on HWY-1	
23	2862 Pacific Coast HWY	
24	22 ft east of no parking sign C44 on HWY-1	
25	.02 miles west of pole #1781897E on bike path	
26	.01 west of bike path entrance from Emma Wood CG	