

Leaf Peepers Half Marathon

Waterbury, VT

Measured Jun 29, 2019

by R. Murphy <rmm.vt@charter.net>



USATF Certification #VT19004JK
Effective 7/29/2019 - 12/31/2029
Drop 0 m/Km, Separation 0.11%

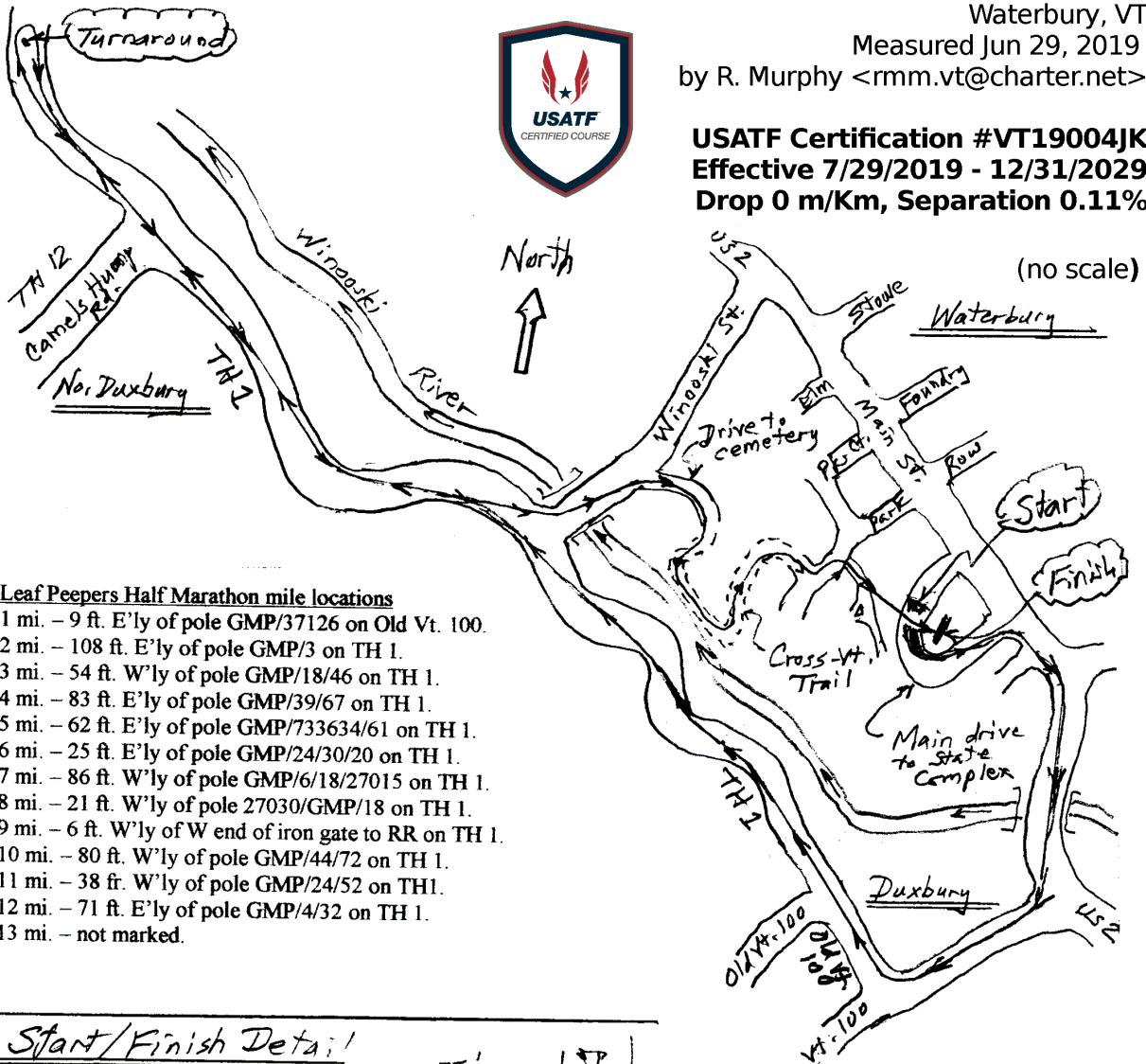

Leaf Peepers Half Marathon mile locations

- 1 mi. - 9 ft. E'ly of pole GMP/37126 on Old Vt. 100.
- 2 mi. - 108 ft. E'ly of pole GMP/3 on TH 1.
- 3 mi. - 54 ft. W'ly of pole GMP/18/46 on TH 1.
- 4 mi. - 83 ft. E'ly of pole GMP/39/67 on TH 1.
- 5 mi. - 62 ft. E'ly of pole GMP/733634/61 on TH 1.
- 6 mi. - 25 ft. E'ly of pole GMP/24/30/20 on TH 1.
- 7 mi. - 86 ft. W'ly of pole GMP/6/18/27015 on TH 1.
- 8 mi. - 21 ft. W'ly of pole 27030/GMP/18 on TH 1.
- 9 mi. - 6 ft. W'ly of W end of iron gate to RR on TH 1.
- 10 mi. - 80 ft. W'ly of pole GMP/44/72 on TH 1.
- 11 mi. - 38 ft. W'ly of pole GMP/24/52 on TH 1.
- 12 mi. - 71 ft. E'ly of pole GMP/4/32 on TH 1.
- 13 mi. - not marked.

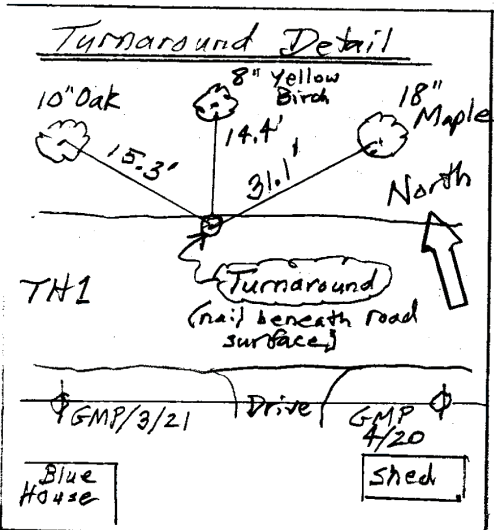
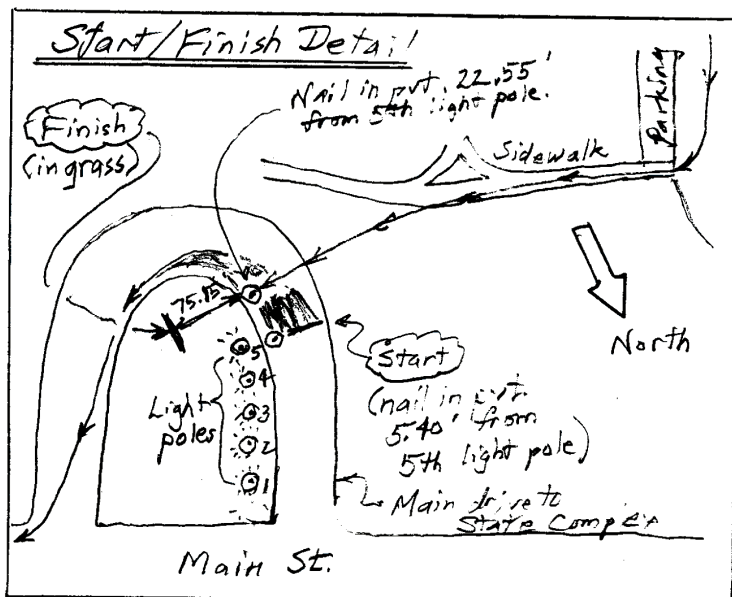



*Road Running Technical Council
USA Track & Field*

Measurement Certificate



Name of the course Leaf Peepers Half Marathon Distance 21.0975 km
 Location (state) VT (city) Waterbury
 Type of course: road race calibration course
 Measuring method: bicycle steel tape electronic distance meter
 Measured by (name, address, phone & e-mail) Robert Murphy, 35 Birchwood Park Dr, Barre VT 05641
802-476-4328; rmm.vt@charter.net
 Race contact (name, address, phone & e-mail) Will Robens, 425 Levesque Dr, Hyde Park VT 05655
802-793-1104
 Date(s) when course measured: Jun 29, 2019
 Number of measurements of entire course: 2 Course Configuration: keyhole
 Elevation (meters above sea level) Start 125 m Finish 125 m Highest 135 m Lowest 120 m
 Straight line distance between start & finish 23 m Drop 0 m/km Separation 0.11 %
 Type of surface: paved 36 % dirt 5 % gravel 59 % grass - % track - %
 Effective date of certification: Jul 29, 2019 Certification code: VT19004JK

Replaces VT03001RF

Notice to Race Director: Use this Certification Code in *all* public announcements relating to your race.

Be It Officially Noted That

Based on examination of data provided by the above named measurer, the course described above and in the map attached is hereby certified as reasonably accurate in measurement according to the standards adopted by the Road Running Technical Council. If *any* changes are made to the course, this certification becomes void, and the course must then be recertified.

Verification of Course — In the event a National Open Record is set on this course, or at the discretion of USA Track & Field, a verification remeasurement may be required to be performed by a member of the Road Running Technical Council. If such a remeasurement shows the course to be short, then all pending records will be rejected and the course certification will be cancelled.

This certification expires on December 31 in the year 2029

AS NATIONALLY CERTIFIED BY:

Justin Kuo

Date: Aug 8, 2019

Justin Kuo • USATF/RRTC Course Certifier • 39 Oakland Road, Brookline, MA 02445-6700
 Phone: 617-731-9889 • Fax: 617-939-0992 • Email: jkuo@usatfne.org