



**ELEVATIONS:**  
(in meters)  
Start: 219.5  
Finish: 199.6  
Highest: 225.6  
Lowest: 199.6



# Christmas Cash Dash Bonanza 5 km Chambersburg, PA

USATF Certificate  
PA15042WB  
Effective 08/3/2015 to 12/31/2025



**Start:** On Grand Point Road 17'49" East of Finish line 18'2" West of Alleg Power pole 1029754 50' 2" west of end of fence for house #2497 Grand Point Road  
**Mile 1:** On Grand Point Road Ext. 10' 1" East of pole CPT 05 SPC 435. Look for guard rail on both sides of road  
**Turn Around:** On Fox Hill Drive 91' 1" East of Speed Limit 30 mph sign. Even with West edge of window of house #3576 Fox Hill Road  
**Mile 2:** On Grand point Ext. 23' 8" East of Speed Limit 30 mph sign. 219' west of center pole CPT 3207 PWO 430. Look for single guard rail.  
**Mile 3:** On Grand Point Rd even with center of barn driveway 44' 5" NE of pole 41.  
**Finish:** On Grand Point Rd in front of Chambersburg 1<sup>st</sup> Church of Christ 55' 7" SW of pole Allg Pwr 1249743 & 39' 7" NE of edge of curb to parking lot.  
**\* Runners must stay on South side of Grand Point Road after mile 2.**

Measured by:  
Tim O'Keefe  
7-20-2015

## Finish

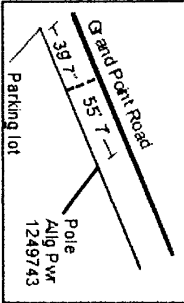

## Start

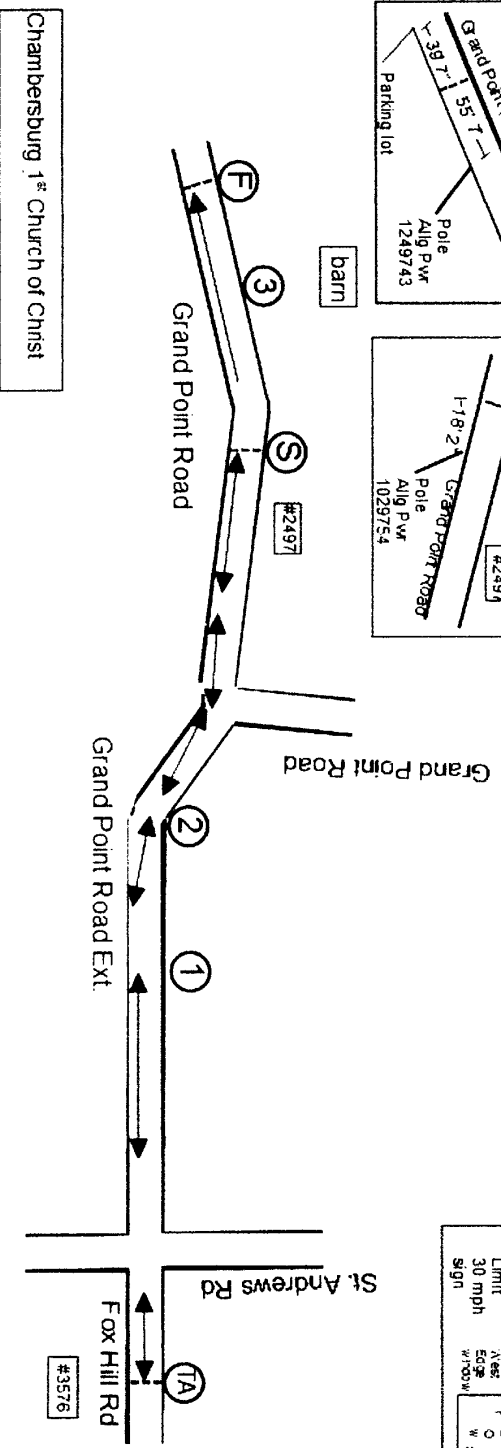
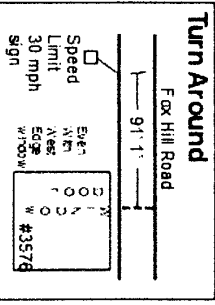
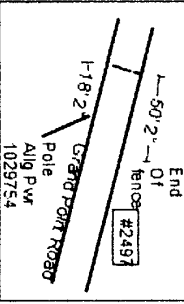

Chambersburg 1<sup>st</sup> Church of Christ



**Road Running Technical Council**  
**USA Track & Field**  
**Measurement Certificate**



Name of the course CHRISTMAS CASH DASH BONANZA 5K Distance 5 km  
Location (state) PENNSYLVANIA (city) CHAMBERSBURG  
Type of course: road race ☒ calibration ☐ track ☐ Configuration: SAME OUT/BACK (1 TIME)  
Type of surface: paved 100 % dirt - % gravel - % grass - % track - %  
Elevation (meters above sea level) Start 219.5 Finish 199.6 Highest 225.6 Lowest 199.6  
Straight line distance between start & finish 533.1 meters Drop 4.0 m/km Separation 10.7 %  
Measured by (name, address, phone & e-mail) TIM O'KEEFE, 7214 LIMESTONE LANE,  
MIDDLETOWN, MD 21769 301-371-9562 timrunr@aol.com  
Race contact (name, address, phone & e-mail) TIM FISLER, 11699 HADES CHURCH RD.,  
GREEN CASTLE, PA 17225 717-496-7431 timfisler@mrisc.com  
Measuring Methods: bicycle ☒ steel tape ☐ electronic distance meter ☐  
Number of measurements of entire course: 2 Date(s) when course measured: 07/20/15  
Race date: 12/06/15 Course certification effective date: 08/13/15  
Certification code: PA15042WB

Notice to Race Director: Use this Certification Code  
in **all** public announcements relating to your race.

***Be It Officially Noted That***

Based on examination of data provided by the above named measurer, the course described above and in the map attached is hereby certified as reasonably accurate in measurement according to the standards adopted by the Road Running Technical Council. If **any** changes are made to the course, this certification becomes void, and the course must then be recertified.

**Verification of Course** — In the event a National Open Record is set on this course, or at the discretion of USA Track & Field, a verification remeasurement may be required to be performed by a member of the Road Running Technical Council. If such a remeasurement shows the course to be short, then all pending records will be rejected and the course certification will be cancelled.

***This certification expires on December 31 in the year***

**2025**

**AS NATIONALLY CERTIFIED BY:**

  
William J. Belleville • USATF/RRTC Certifier  
2902 Morris Road, Ardmore, PA 19003 • (610) 649-4278 • wjbelleville1@verizon.net

Date: 08/13/15