

Charlotte Racefest
13.1 Miles
SouthPark Area
Charlotte, N.C.

USATF Certificate# NC16003DW
Effective Dates: April 7, 2016
Thru December 31, 2026

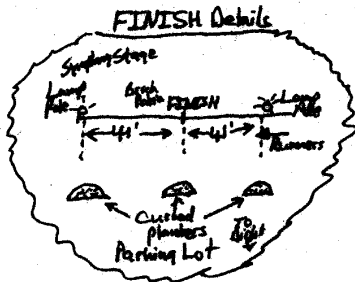

Course Measured by: *Joseph P. Ford*
3-28-16
jpfssports@aol.com

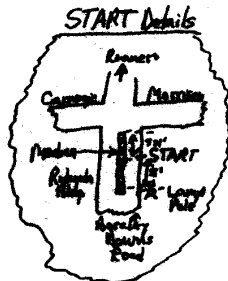
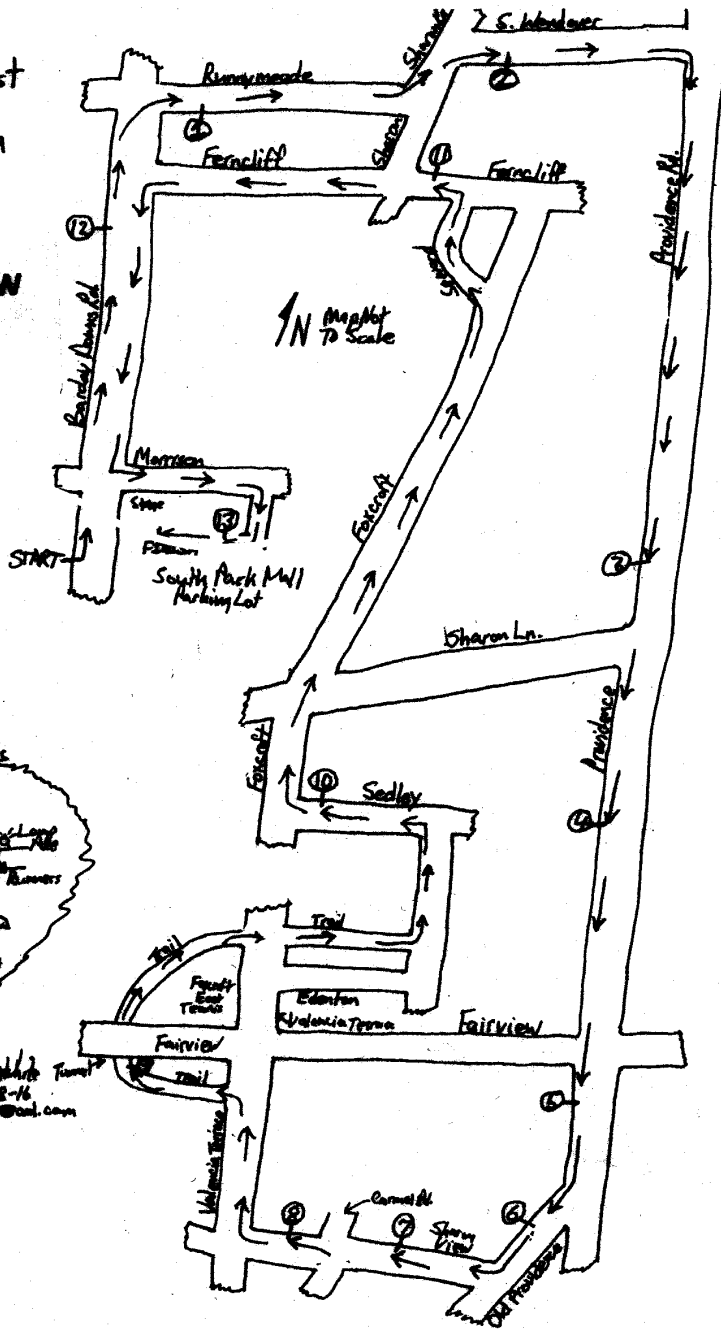

Location of Key Points

- START- On Barclay Downs in front of the Rotunda Bldg. Point is 331' South of end of concrete median and 15' North of a lamp pole on sidewalk.
 1 Mile- On Runnymede across from middle school and in front of Res #3809. Point is 128' 9" West of Fire Hydrant #787 and 41' East of metal sewer cover.
 2 Mile- On South Wandoover in front of Res #2025. Point is 14' East of Forest Dr.
 3 Mile- On Providence Rd. beside Providence United Methodist Church. Point is 100' South of metal cover for traffic signal and 43' North of water meter.
 4 Mile- On Providence Rd. near Tennis Courts to Camden-Pinehurst Apt Complex. Point is 96' 3" South of Storm Drain and 49' 6" North of Duke Power pole #84-345. Point is South of McMullan Creek.
 5 Mile- On Providence Rd. South of Providence Road Church of Christ. Point is 92' 3" South of pole SP5K-6-340 and 5' 3" North of a metal sewer cover.
 6 Mile- On Old Providence Rd. beside apt complex. Point is 98' South of Duke Power pole #SPC00441 and 74' 1" North of power pole #SPCA45
 7 Mile- On Sharon View Rd. in front of entrance to "Summer Lake" and in front of Res #5323. Point is 1' 9" North of water meter on sidewalk.
 8 Mile- On Sharon View Rd. beside rear parking lot entrance to Carmel Presbyterian Church. Point is 38' 3" West of two water meters on sidewalk.
 9 Mile- On Fencible Trail at the Intersection of Fairview St. Tunnel. Point is 79' West of Valenda Terrace.
 10 Mile- On Sedley Trail in front of Res #2332. Point is 30' East of Fencible.
 11 Mile- On Fencible in front of Res #2450 driveway. Point is 69' 2" East of AT&T Underground Cable Box.
 12 Mile- On Barclay Downs Rd. in front of Res #2618. Point is 21' North of water meter in Resl #618 yard.
 13 Mile- In SouthPark Mall Parking Lot behind DoubleTree Hotel Parking Deck. (#500 Morrison). Point is 57' East of Fire Hydrant and 35' 10" West of Median with stop Sign.
 FINISH- In SouthPark Mall Parking Lot at Symphony Park. Point is directly in front of Amphitheater stage. Point is 41' East of metal lamp pole and 41' West of another metal lamp pole in sidewalk.



Road Running Technical Council
USA Track & Field
Measurement Certificate



Name of the course Charlotte Racefest Half Marathon Distance 21.0975 km
 Location (state) North Carolina (city) Charlotte
 Type of course: road race calibration course track
 Measuring methods: bicycle steel tape electronic distance meter
 Measured by (name, address, phone & e-mail) Danny White, 2119 Rice Road, Marion, SC 29571
(843)230-8648, rmssports@aol.com
 Race contact (name, address, phone & e-mail) Danny White, 2119 Rice Road, Marion, SC 29571
(843)230-8648, rmssports@aol.com
 Date(s) when course measured: March 28, 2016
 Number of measurements of entire course: 2 Course Configuration: One Loop 1 Time
 Elevation (meters above sea level) Start 207.87 Finish 209.70 Highest 224.03 Lowest 173.43
 Straight line distance between start & finish 76.20 m Drop -0.09 m/km Separation 0.36 %
 Type of surface: paved 100 % dirt _____ % gravel _____ % grass _____ % track _____ %
 Effective date of certification: April 7, 2016 Certification code: NC16003DW

Notice to Race Director: Use this Certification Code in all public announcements relating to your race.

Be It Officially Noted That

Based on examination of data provided by the above named measurer, the course described above and in the map attached is hereby certified as reasonably accurate in measurement according to the standards adopted by the Road Running Technical Council. If any changes are made to the course, this certification becomes void, and the course must then be recertified.

Verification of Course — In the event a National Open Record is set on this course, or at the discretion of USA Track & Field, a verification remeasurement may be required to be performed by a member of the Road Running Technical Council. If such a remeasurement shows the course to be short, then all pending records will be rejected and the course certification will be cancelled.

This certification expires on December 31 in the year 2026

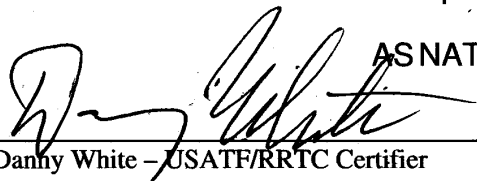
 AS NATIONALLY CERTIFIED BY:

Date: April 7, 2016

Danny White – USATF/RRTC Certifier
 2119 Rice Road, Marion, SC 29571, (843)230-8648, rmssports@aol.com