



**Road Running Technical Council
USA Track & Field
Measurement Certificate**



Name of the course Rock Bridge Corporate 5k Distance 5 km
Location (state) MO (city) Columbia
Type of course: Road Race
Measuring Methods: Bicycle
Measured By Tom May - 3913 Gailcrest Drive - Columbia, MO 65203 - (573) 819-1515 - tmay@mfaoil.com
Race Contact Tom May - 3913 Gailcrest Drive Columbia, MO 65203 - 573-819-1515 - tmay@mfaoil.com
Date(s) when course measured: 10/22/2020
Number of measurements of entire course: 2 Course Configuration: loop
Elevation (meters above sea level) Start 230.73 Finish 227.99 Lowest 219.15 Highest 230.73
Straight line distance between start and finish 240 m Drop 0.55 m/km Separation 4.80 %
Type of surface: Paved 100 % Dirt 0 % Gravel 0 % Grass 0 % Track 0 %
Effective date of certification: October 28, 2020 Certification code: MO20008MU

Note to Race Director: Use this Certification Code
in all public announcements relating to your race.

Be It Officially Noted That

Based on examination of data provided by the above named measurer, the course described above and in the map attached is hereby certified as reasonably accurate in measurement according to the standards adopted by the Road Running Technical Council. If any changes are made to the course, this certification becomes void, and the course must then be recertified.

Verification of Course --- In the event a National Open Record is set on the course, or at the discretion of USA Track & Field, a verification measurement may be required to be performed by a member of the Road Running Technical Council. If such a remeasurement shows the course to be short, then all pending records will be rejected and the course certification will be cancelled.

This certification expires on December 31 of the year: **2030**

AS NATIONALLY CERTIFIED BY:

Date: October 28, 2020

Martin Updike - USATF/RRTC Certifier - 812 Eastside Blvd, Muskogee OK 74403
(918) 577-1956 - martin@i40raceservice.com



USATF Certificate;
 MO20008MU
 Effective: 10/28/2020
 Through: 12/31/2030

NORTH DRIVE COLUMBIA DR

COLUMBIA, MISSOURI

THIS COURSE WAS MEASURED USING THE SHORTEST POSSIBLE ROUTE USING THE FULL WIDTH OF THE ROAD EXCEPT ON E. SOUTHAMPTON WHERE RUNNERS SHOULD USE THE FULL WIDTH OF THE BIKE LANE

ROCK BRIDGE PARK

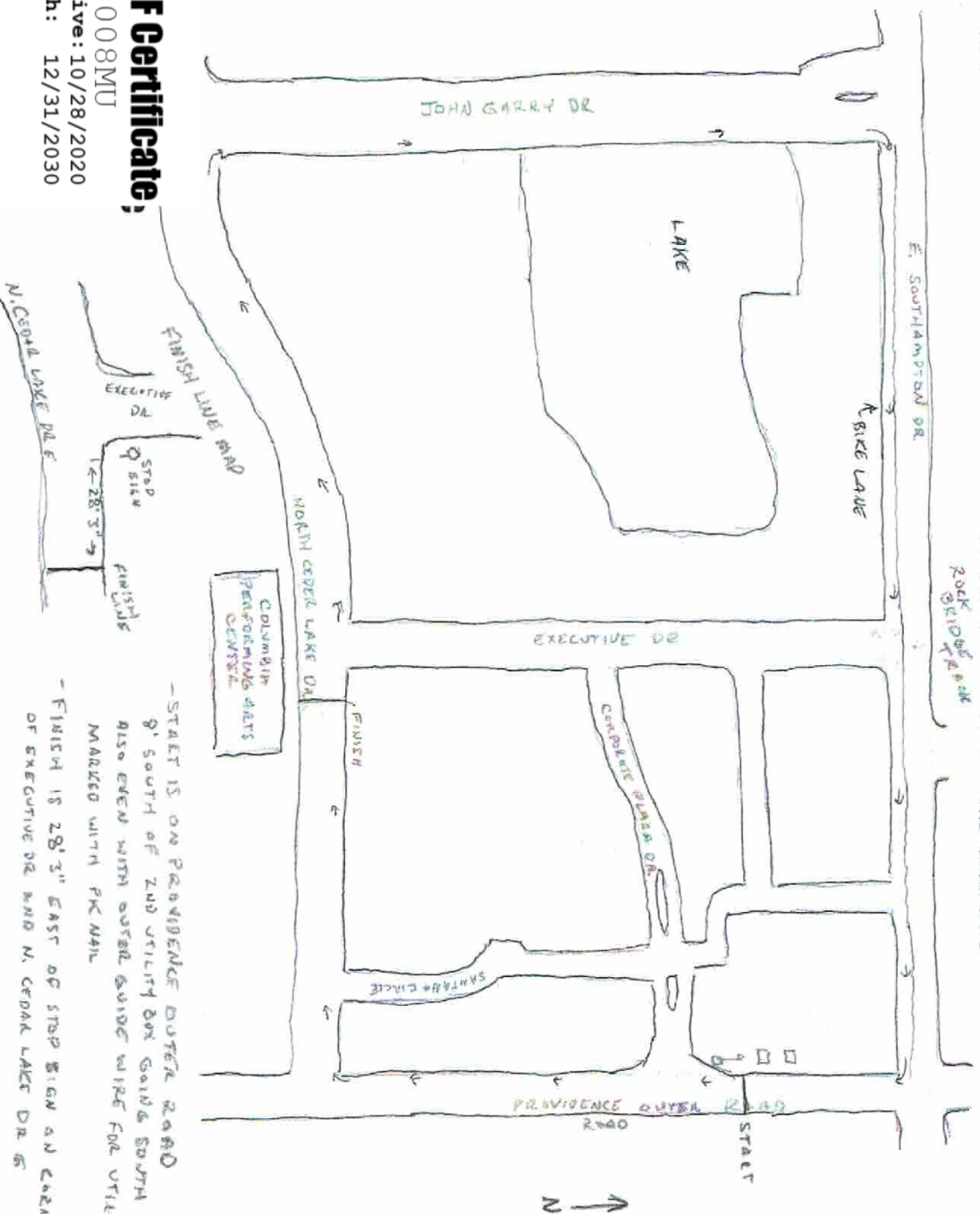

- START IS ON PROVIDENCE DRIVE ROAD 8' SOUTH OF 2ND UTILITY BOX GOING SOUTH ALSO EVEN WITH OUTER GUIDEWIRE FOR UTILITY POLE MARKED WITH PLY NAIL
- FINISH IS 28' 3" EAST OF STOP SIGN ON CORNER OF EXECUTIVE DR AND N. CEDAR LAKE DR
- RUNNERS SHOULD USE THE BIKE LANE ON E. SOUTHAMPTON DR
- THIS IS A THREE + LOOP COURSE