



**Road Running Technical Council
USA Track & Field**

Measurement Certificate



Name of the course Marsh Lane Calibration Course Distance 1092.92 FT
 Location (state) AL (city) Oxford
 Type of course: Calibration
 Measuring Methods: Steel Tape
 Measured By Robert Powers - 107 PITTS DRIVE - ANNISTON, AL 36201 - (256) 282-5353 - leisure1021@gmail.com
 Race Contact N/A
 Date(s) when course measured: February 7, 2026
 Number of measurements of entire course: 2 Course Configuration: point to point
 Elevation (meters above sea level) Start 184.40 Finish 184.40 Lowest N/A Highest N/A
 Straight line distance between start and finish 1092.92 FT Drop: 0.00 m/km Separation 100.00 %
 Type of surface: Paved 100 % Dirt 0 % Gravel 0 % Grass 0 % Track 0 %
 Effective date of certification: February 9, 2026 Certification code: AL26007JE

Note to Race Director: Use this Certification Code in all public announcements relating to your race.

Be It Officially Noted That

Based on examination of data provided by the above named measurer, the course described above and in the map attached is hereby certified as reasonably accurate in measurement according to the standards adopted by the Road Running Technical Council. If any changes are made to the course, this certification becomes void, and the course must then be recertified.

Verification of Course --- In the event a National Open Record is set on the course, or at the discretion of USA Track & Field, a verification measurement may be required to be performed by a member of the Road Running Technical Council. If such a remeasurement shows the course to be short, then all pending records will be rejected and the course certification will be cancelled.

This certification expires on December 31 of the year: **2036**

Jon Elmore

AS NATIONALLY CERTIFIED BY:

Date: February 11, 2026

Jon Elmore - USATF/RRTC Certifier - 3428 Tanglewood Dr SW, Decatur AL 35603
(256) 476-3517 - jklca5@att.net

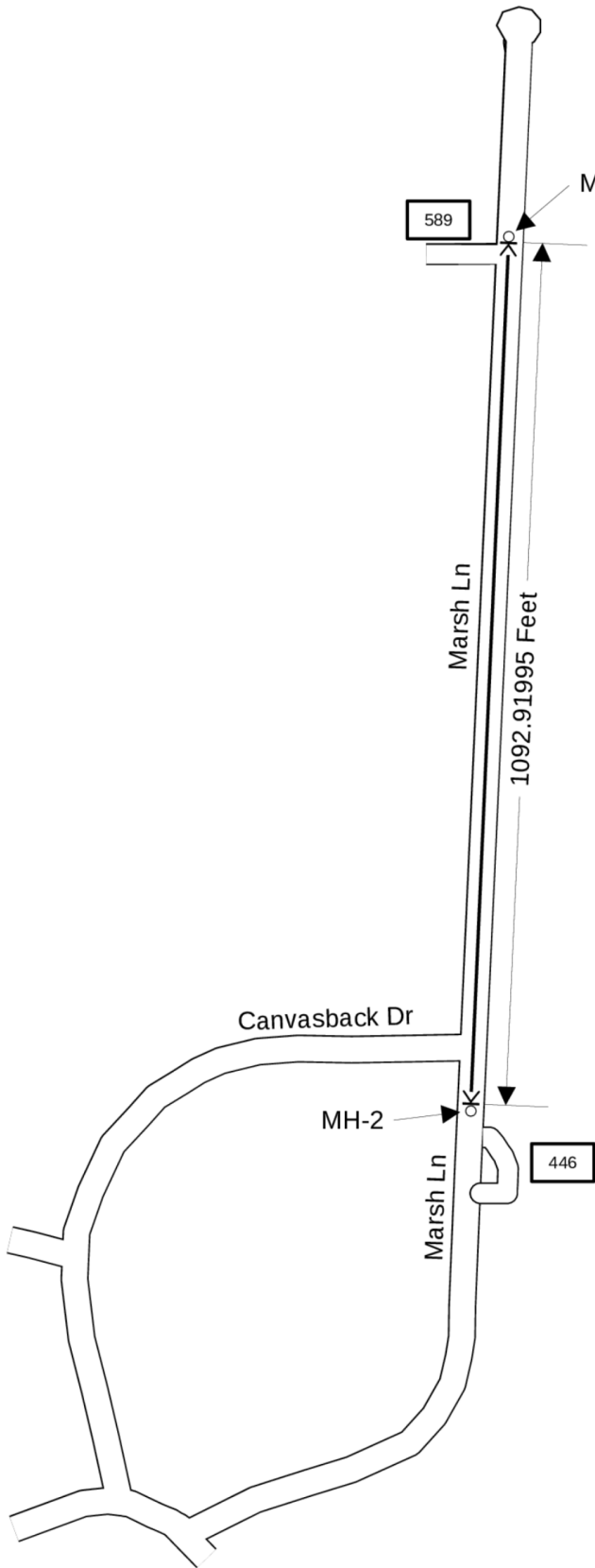

Marsh Lane Calibration Course
1092.91995 Feet
Oxford, Alabama

Measurement from South edge of lid at Manhole Cover 1 (MH-1) to the North edge of lid at raised MH-2 is 1,092.91995 feet (333.122 meters). MH-1 is in the middle of the road, lined up with the South side of 589 Marsh Lane brick house. MH-2 is first MH on Marsh Lane in the middle of the road, South of Canvasback Dr intersection and North of 446 Marsh Lane driveway.



USATF Certificate

AL26007JE
Effective: 02/09/2026
Through: 12/31/2036